

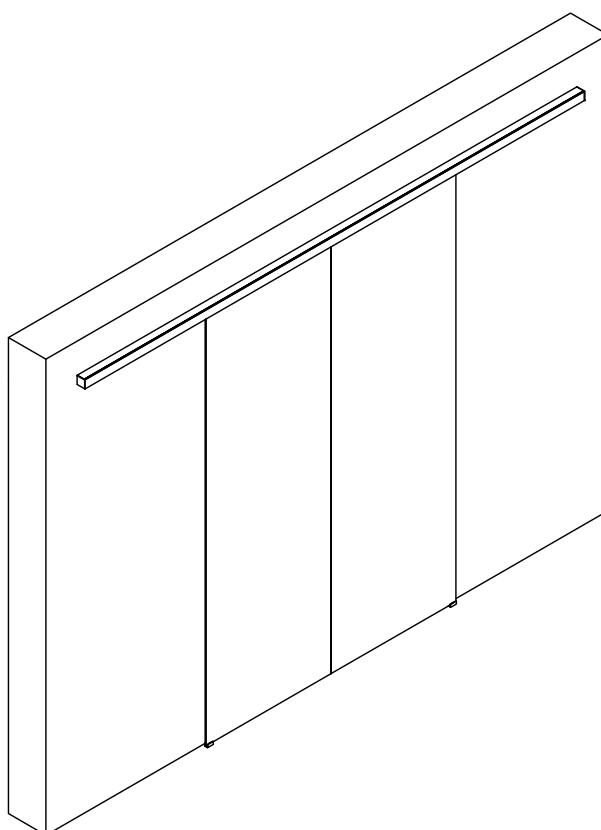

# LM PORTA

ISTRUZIONI DI MONTAGGIO  
ASSEMBLY INSTRUCTIONS  
INSTRUCTIONS DE MONTAGE

INSTALLAZIONI CON BINARIO AD UNA VIA A PARETE CON 2 ANTE  
INSTALLATIONS WITH ONE-WAY WALL TRACK WITH 2 DOORS  
INSTALLATIONS AVEC RAIL SUR MUR UNIQUE AVEC 2 PORTES



## LMP6521C

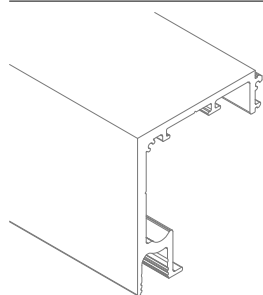

LM5864S

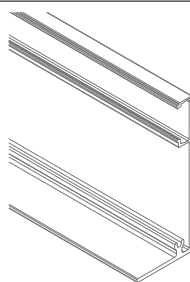
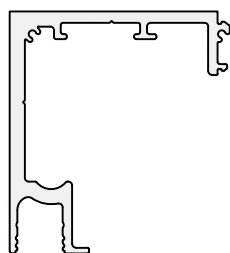

LM0064C

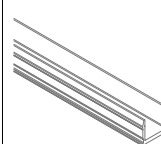
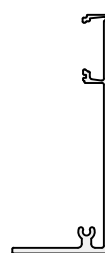

LMC13

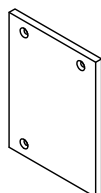

x2  
LM63061TP33

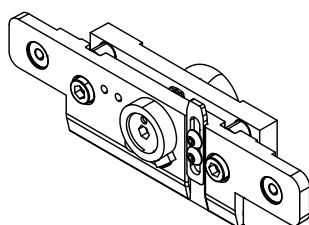

x4  
CERPOS155

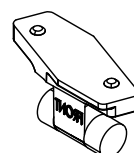

x4  
LMPS-STP55

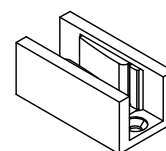

LMGF

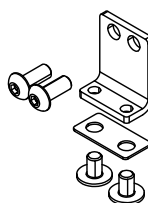

LMSIN-AC55 - (PIASTRA 4F)

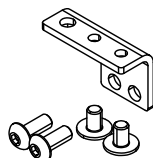

LMSIN-AC55 - (PIASTRA 5F)

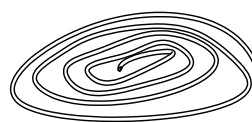

LMSIN-AC55 - (CAVO)

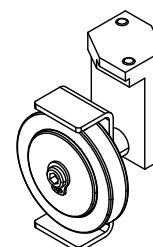

x2  
LMSIN-AC55 - (CARRUCOLA)

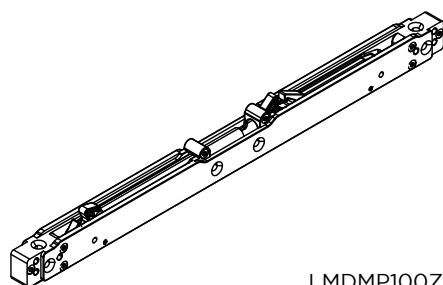

LMEMP100Z

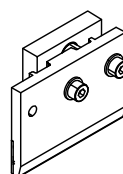

LMPS-PSD55

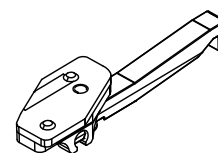

x2  
LMSIN-GA55

LMP6521C

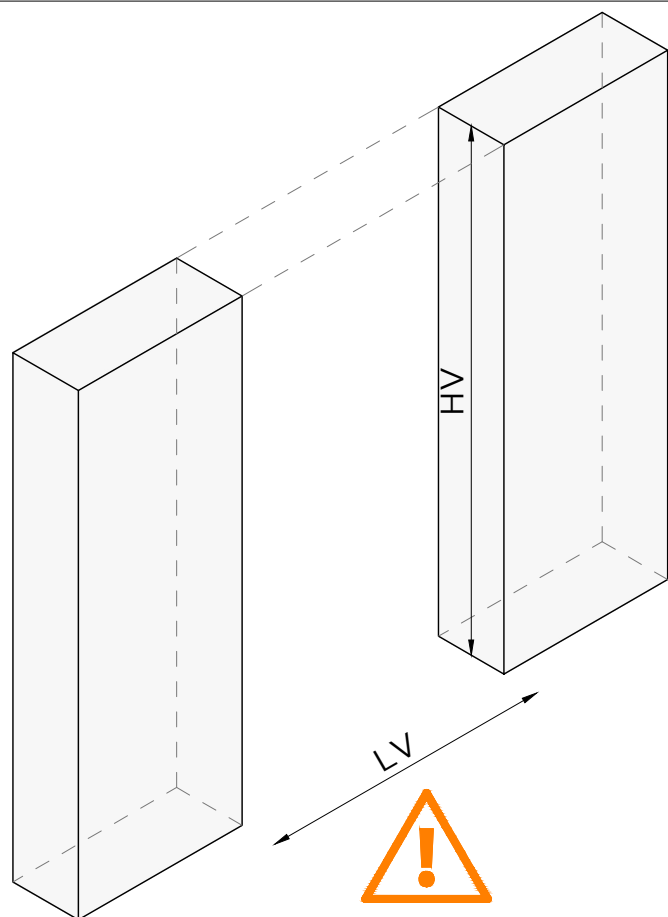

In caso di Maniglia Optional vedi punto -  
In case of Optional Handle see point -  
En cas de poignée optionnelle, voir les point

A

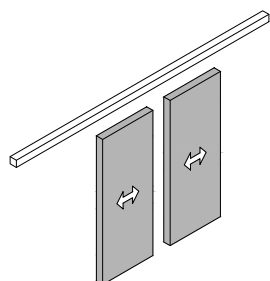
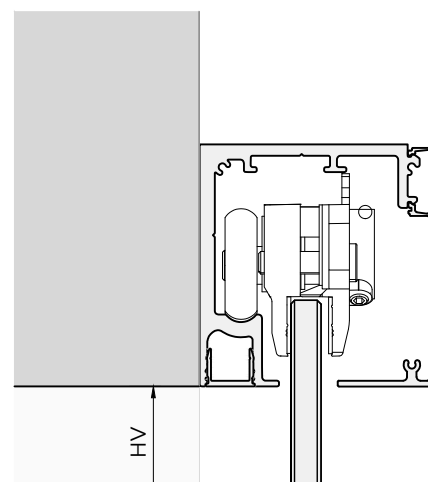
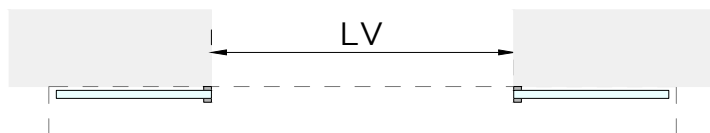
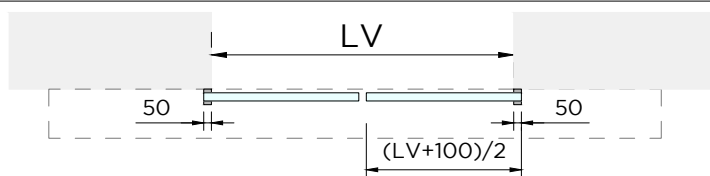

VETRO - GLASS - VERRE  
8mm - 10,8mm

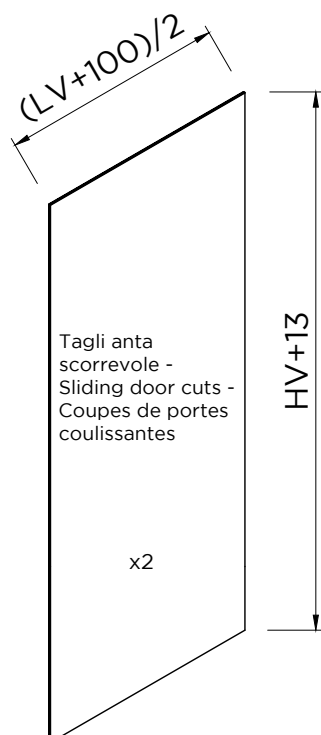

Tagli anta  
scorrevole -  
Sliding door cuts -  
Coupes de portes  
coulissantes

x2

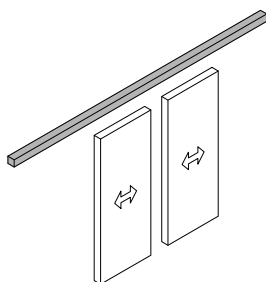

LM5864P

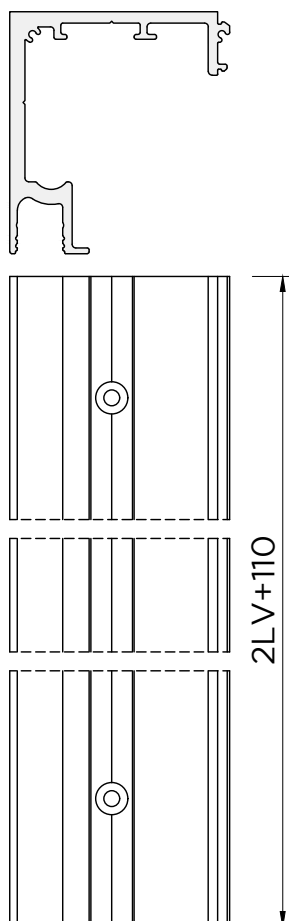

LM0064C

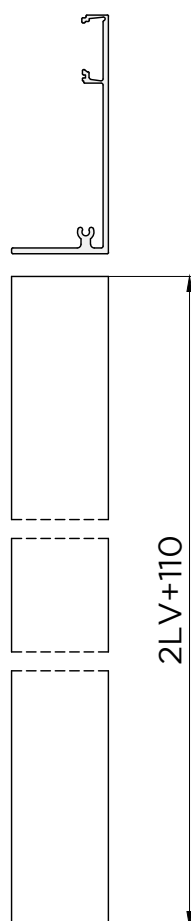

LMC13

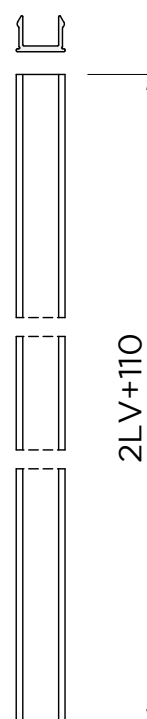

LMP6521C

1

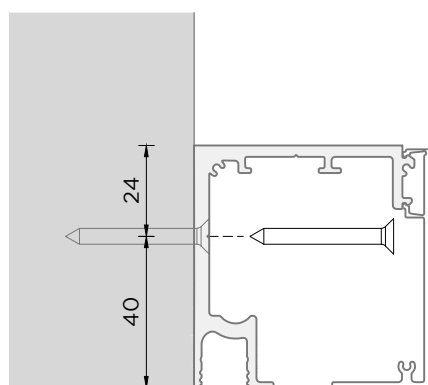

NO KIT

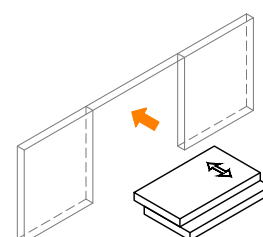
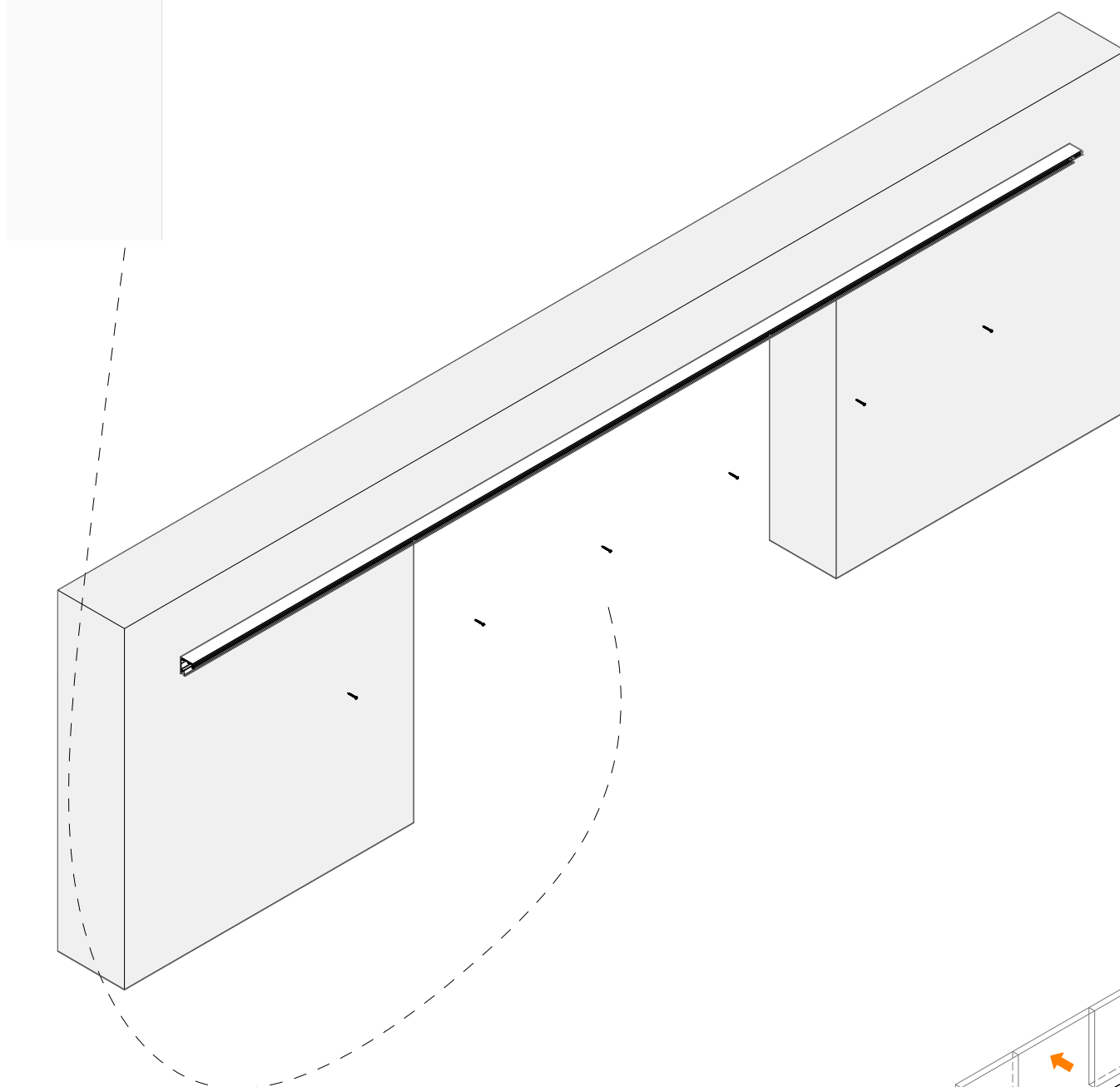
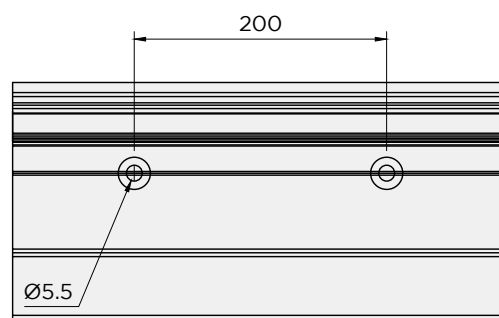

2

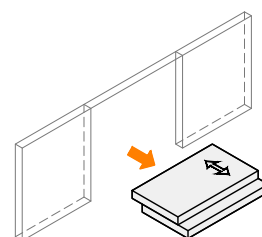
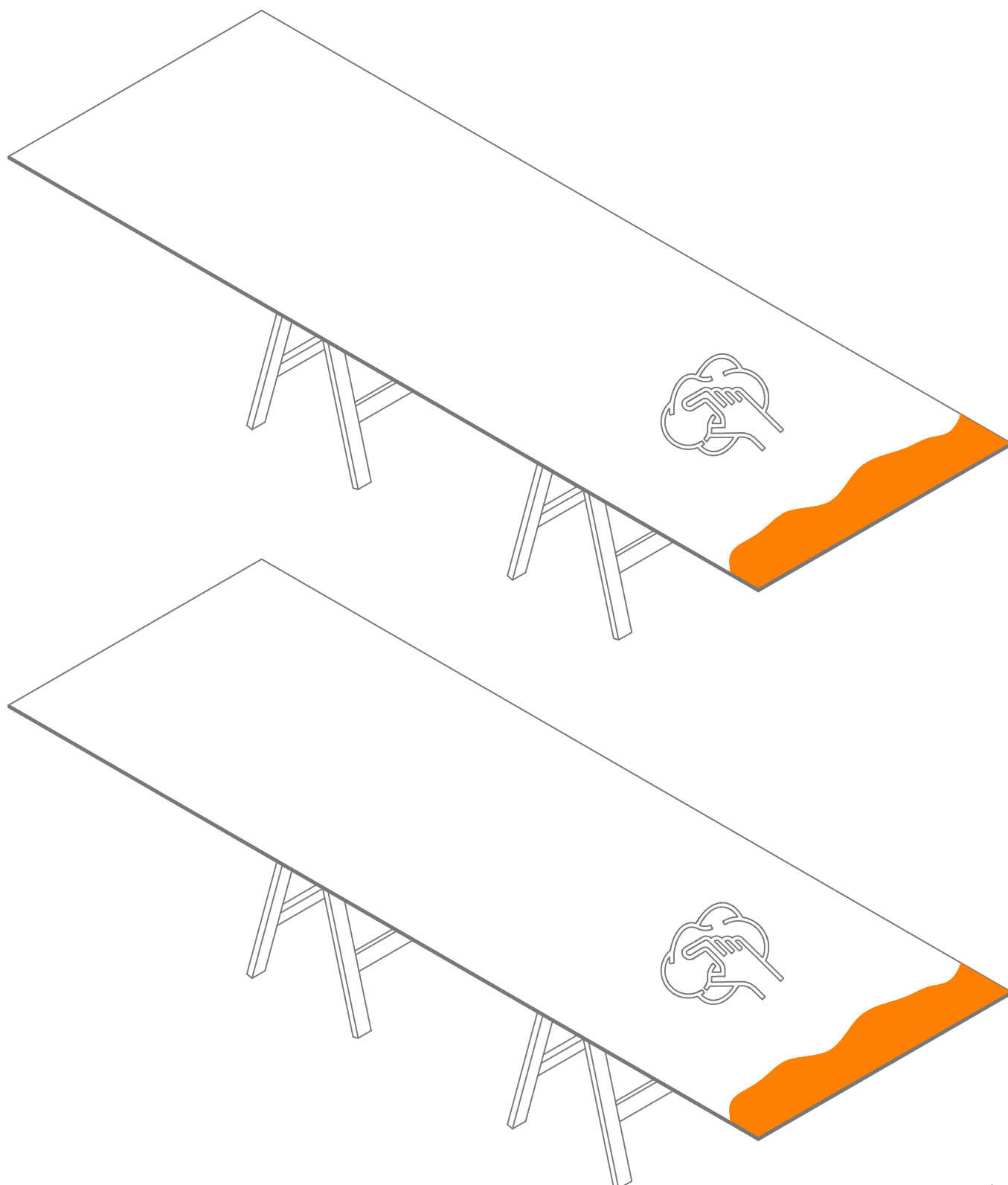

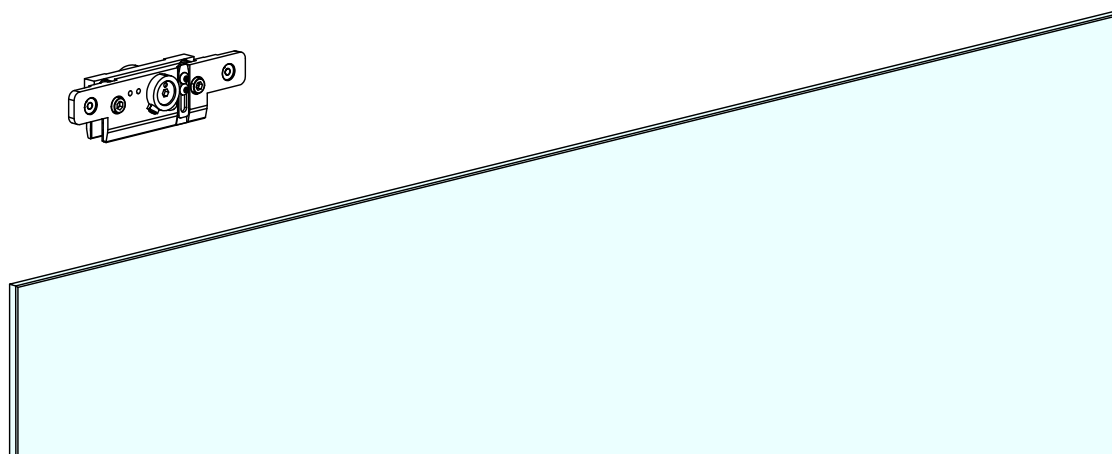
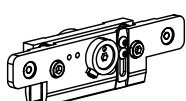
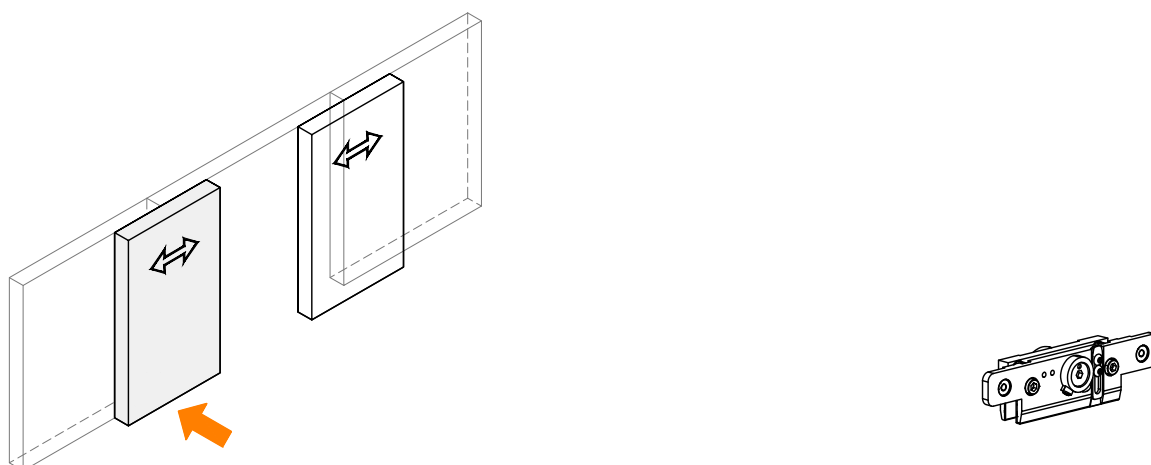
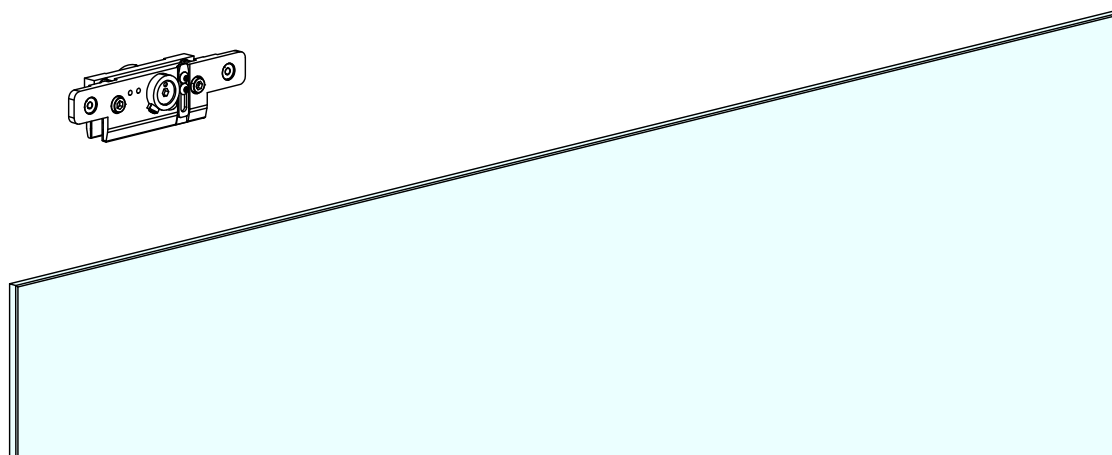
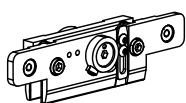
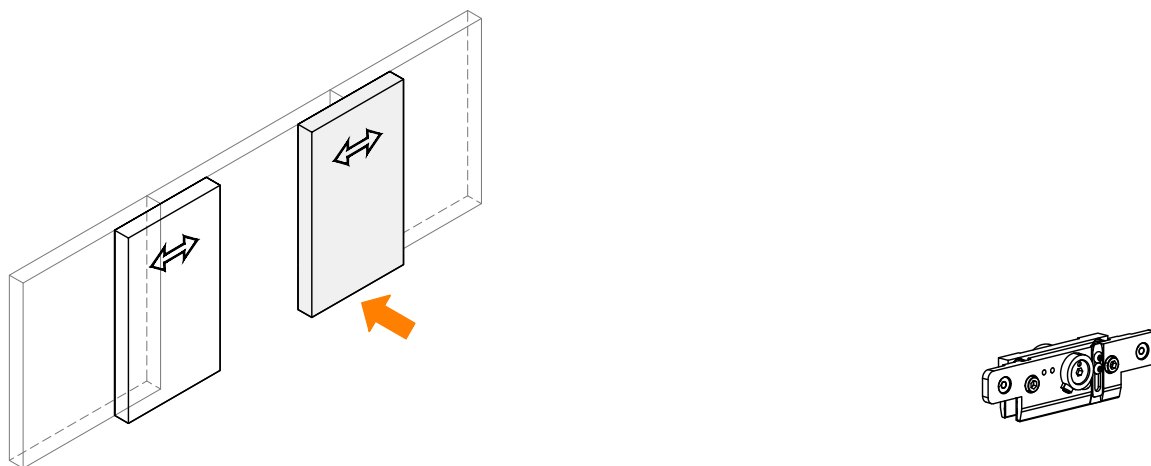

3a x4

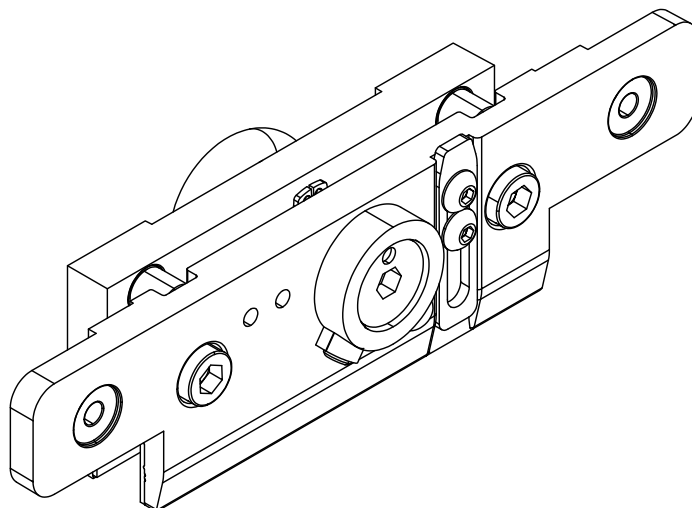

3b x4

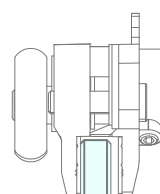
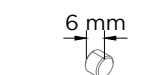
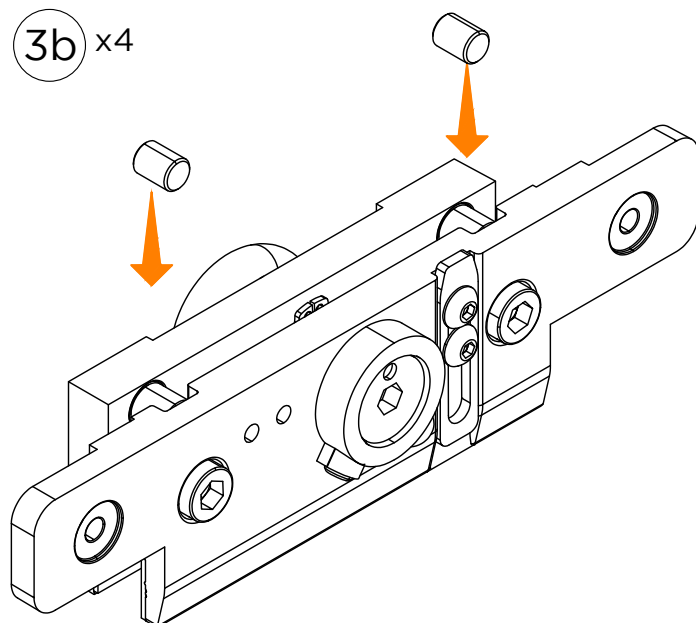

8 - 8.8

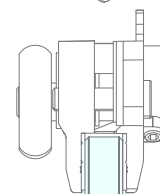

10 - 10.8

3c x4

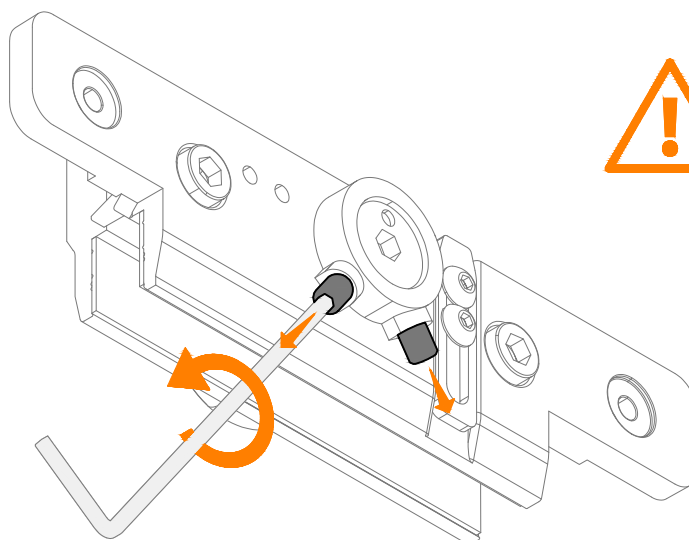



LMP6521C

3d x4

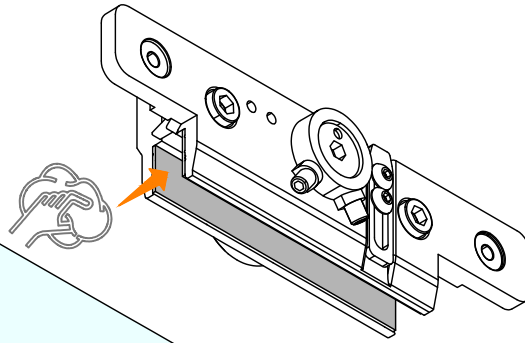

3e x4

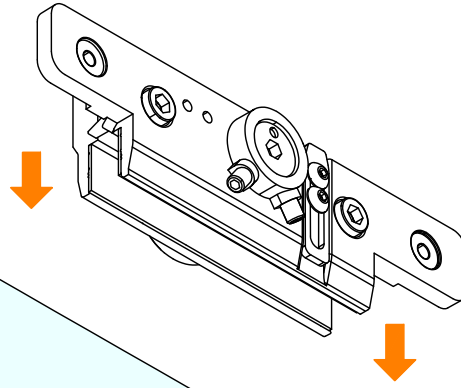

3f x4

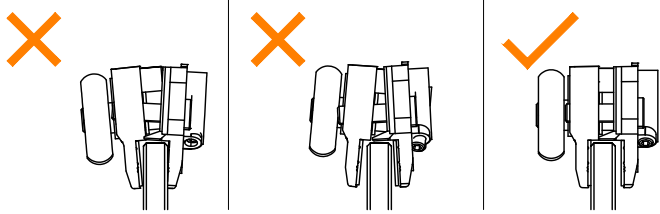
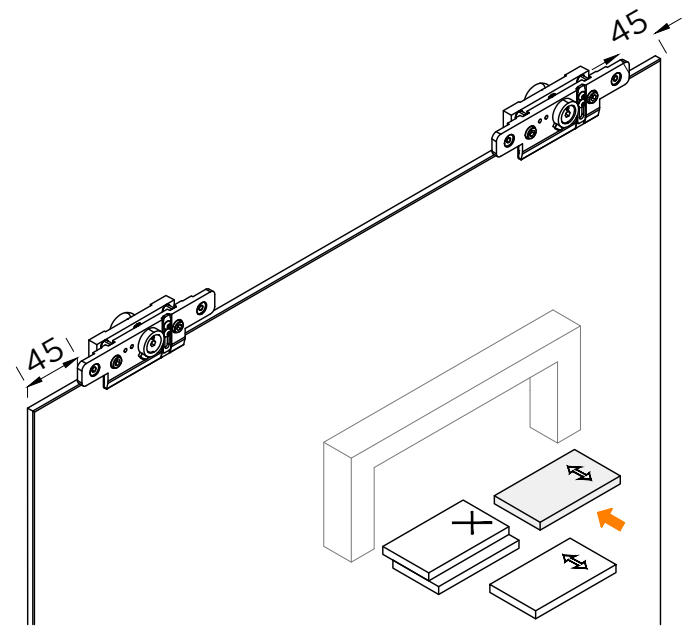
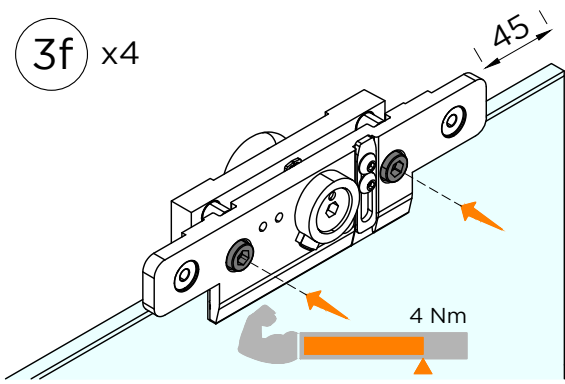

This diagram illustrates the assembly of a sliding door system. It shows a long metal track with rollers being installed. Two orange arrows point to the rollers being inserted into the track. A separate view shows a hand inserting a roller into a track.

This technical diagram illustrates the components of a sliding door system. The main part of the diagram shows a long, narrow door profile with various rollers and tracks. Two orange arrows point to the bottom of the profile, indicating the location of the rollers. Below the profile, a small inset shows a cross-section of the door, with an orange arrow pointing to the bottom edge, indicating the location of the rollers. To the right, a smaller diagram shows the door in its open position, with two orange arrows pointing to the bottom edge, indicating the location of the rollers.

LMP6521C

4a

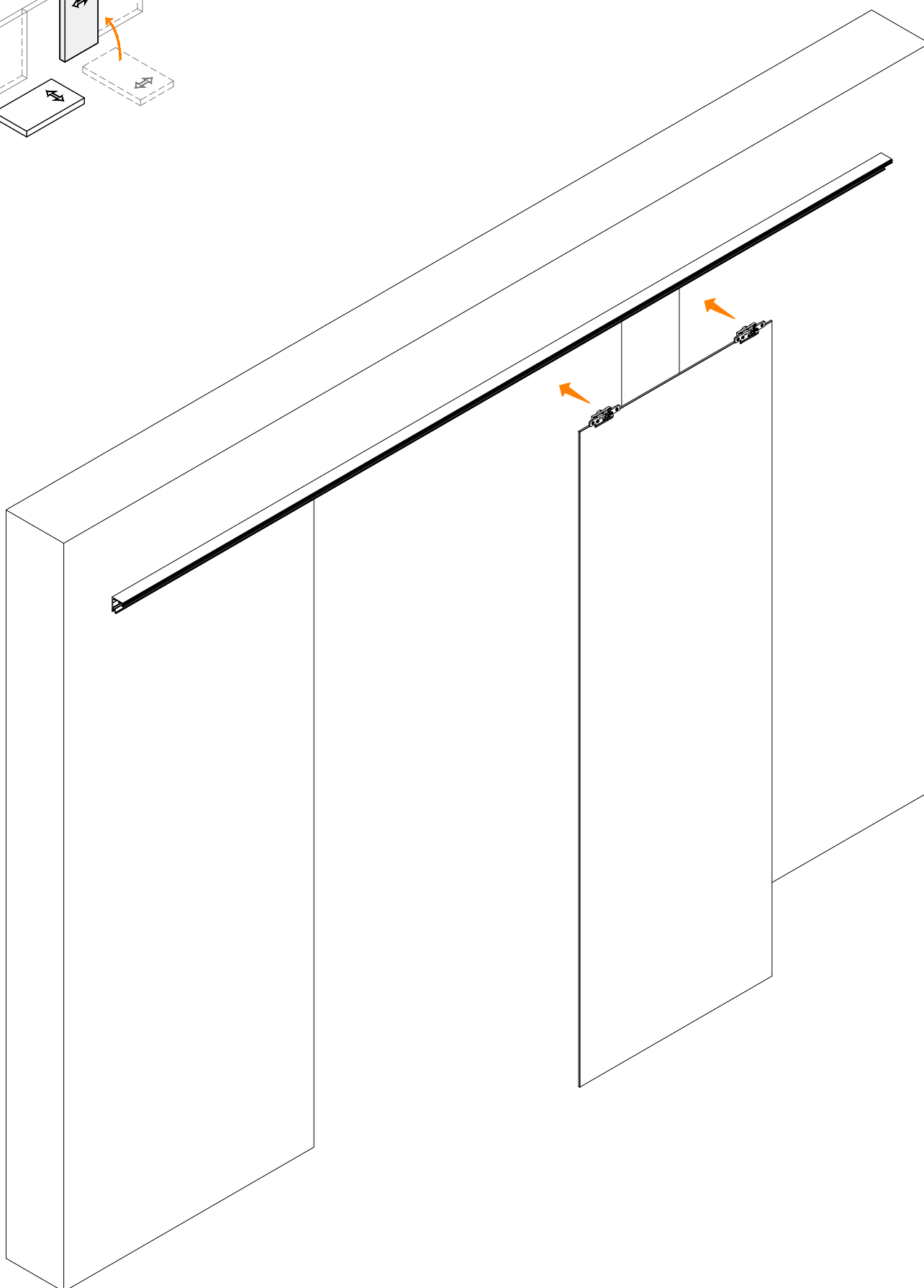
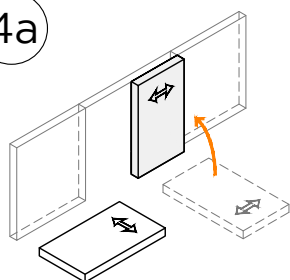

4b

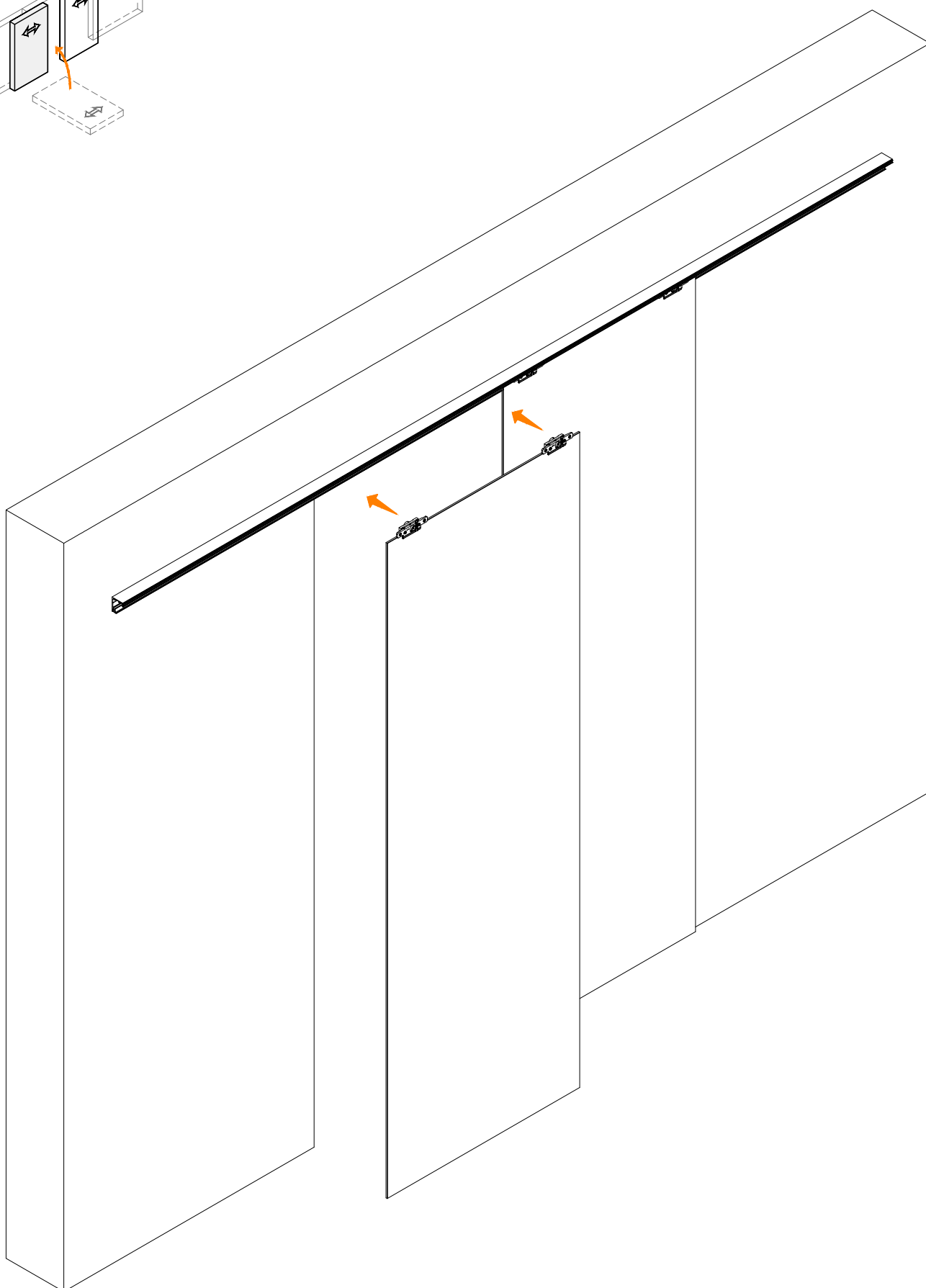
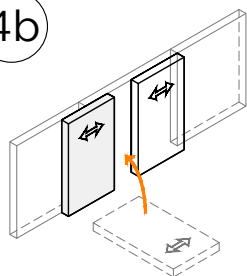

LMP6521C

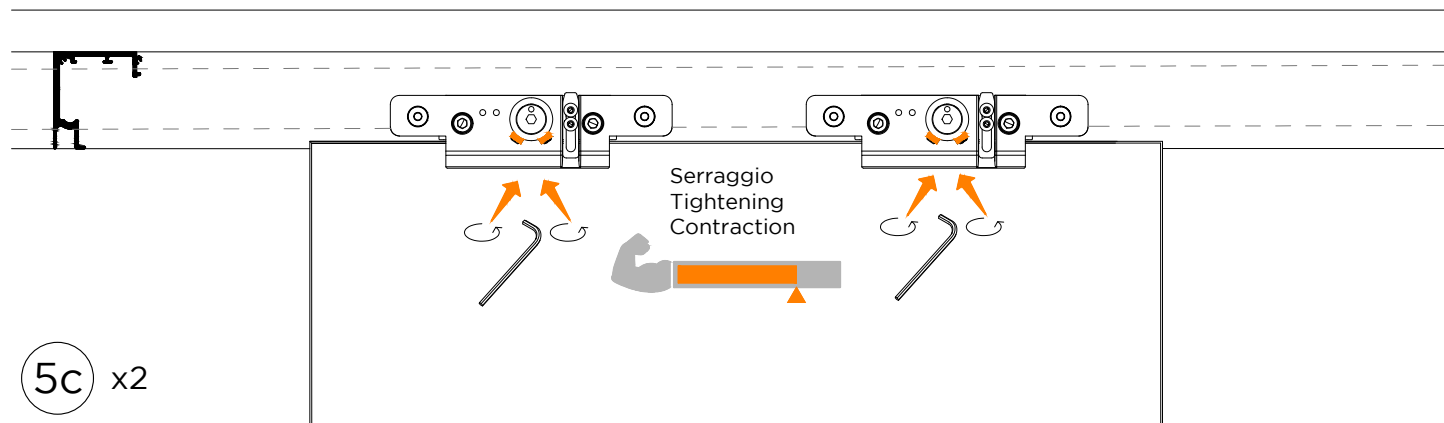
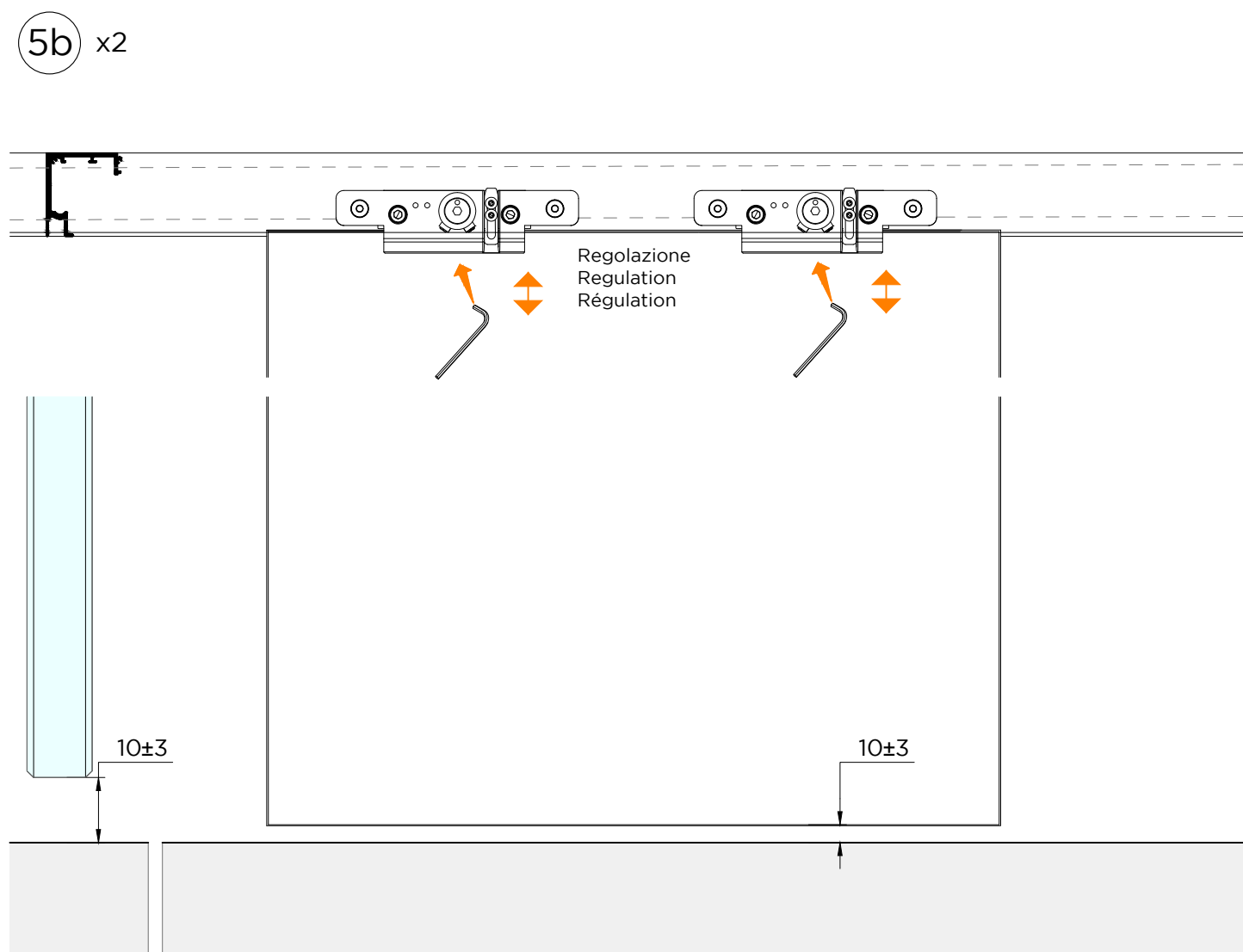
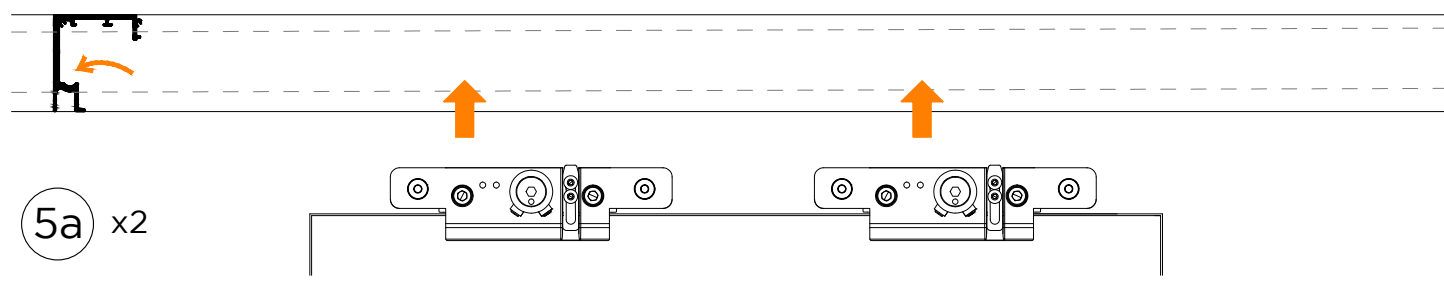

5d x2

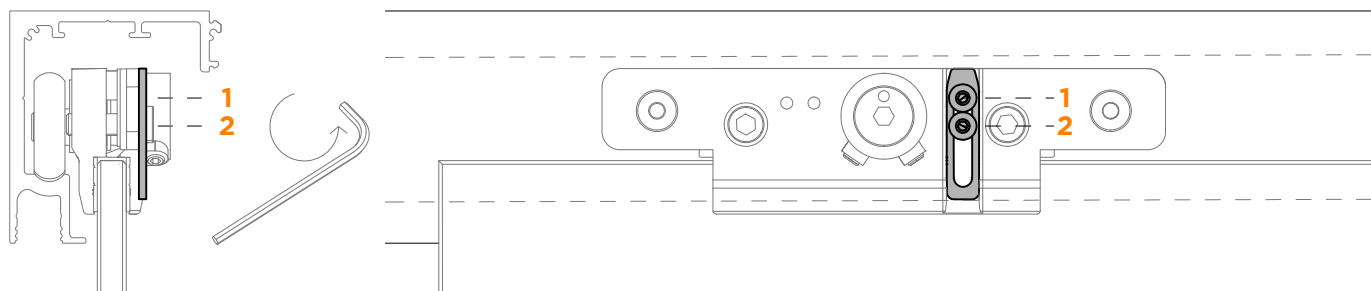

5e x2

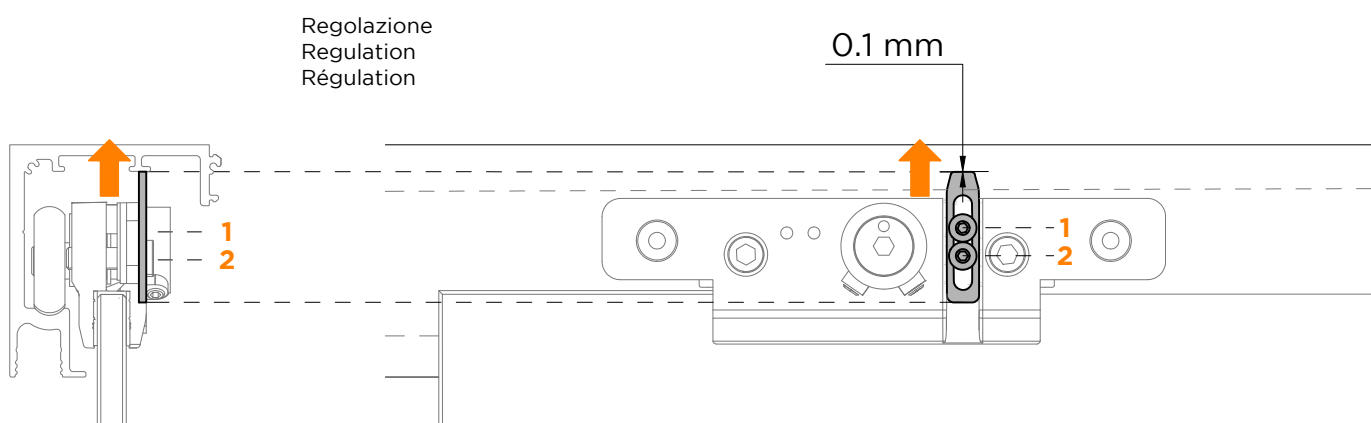

5f x2

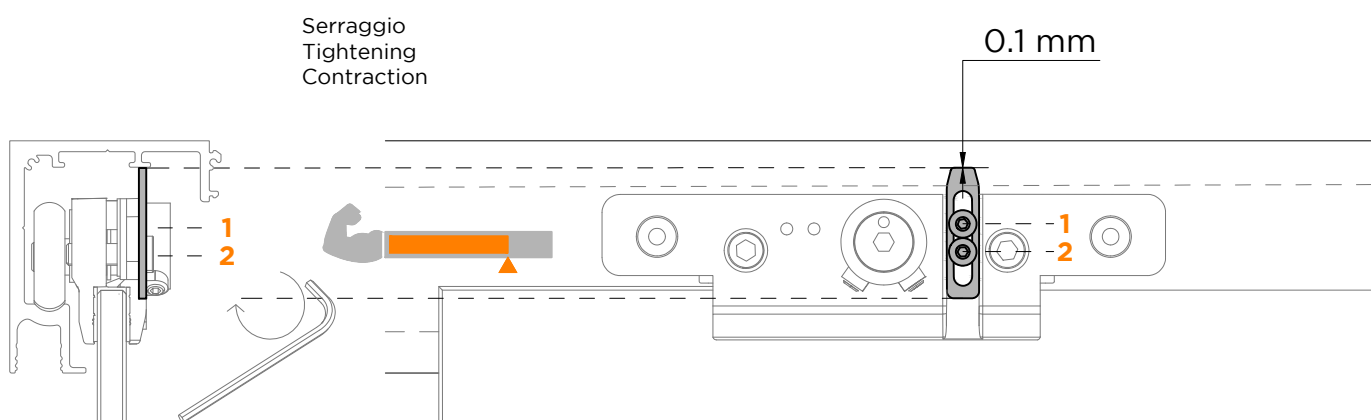

LMP6521C

6a

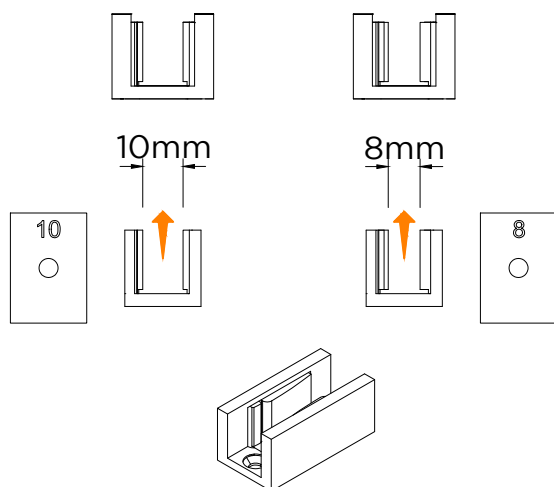

6b

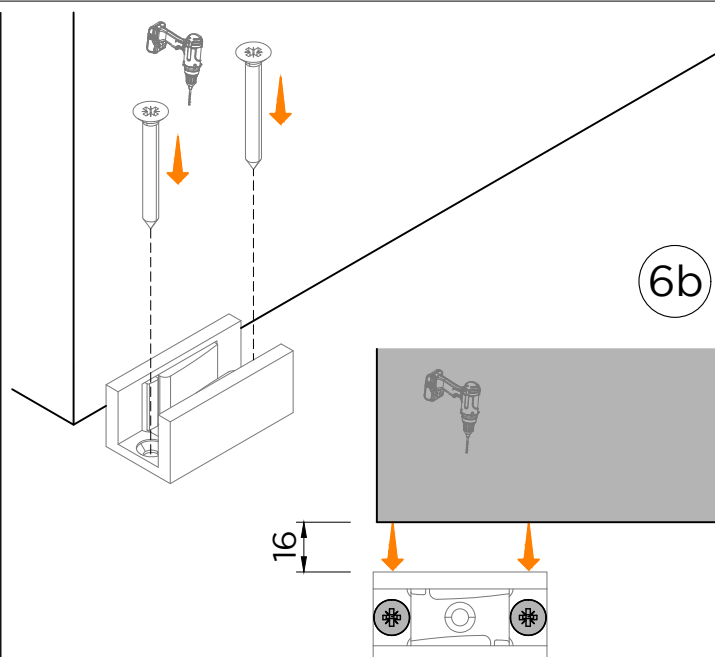

6c

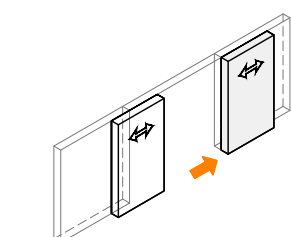
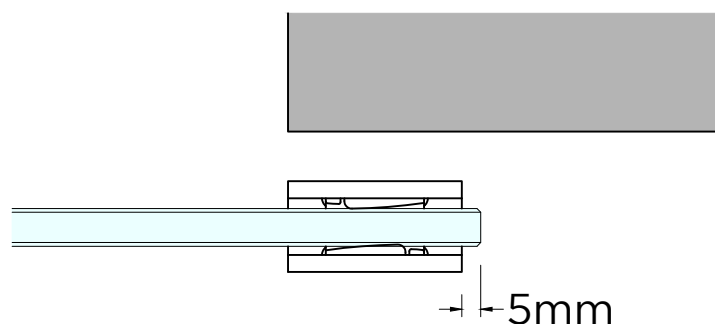
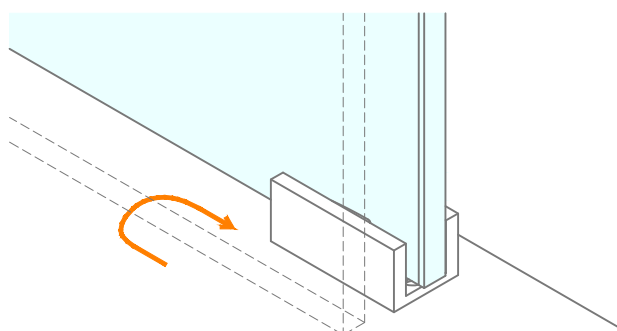
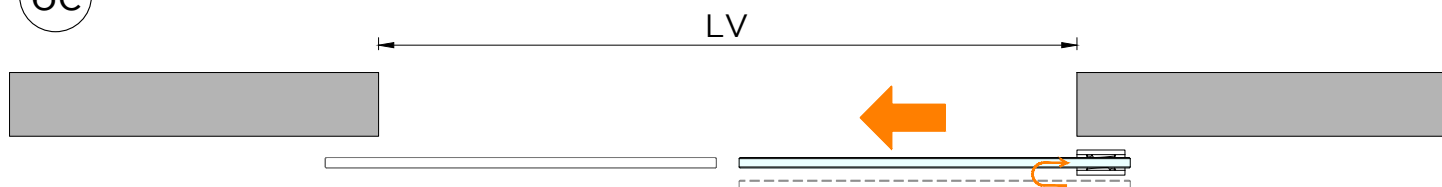

6d

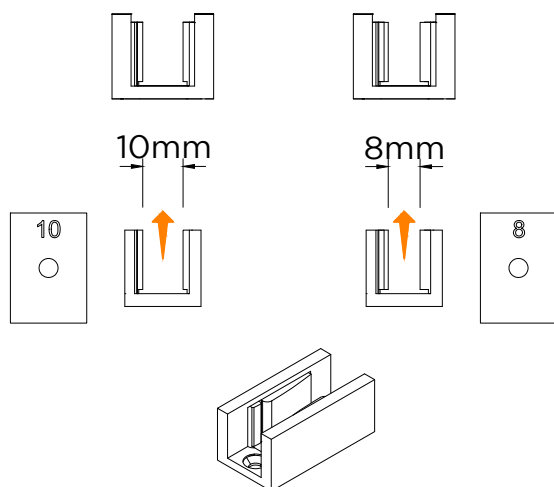

6e

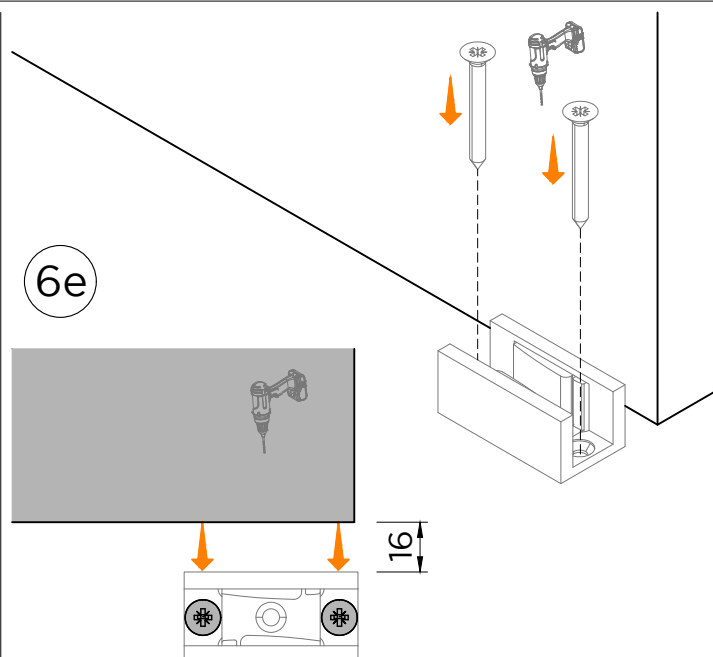

6f

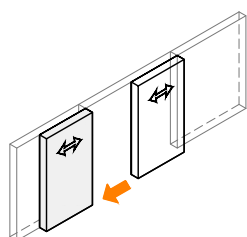
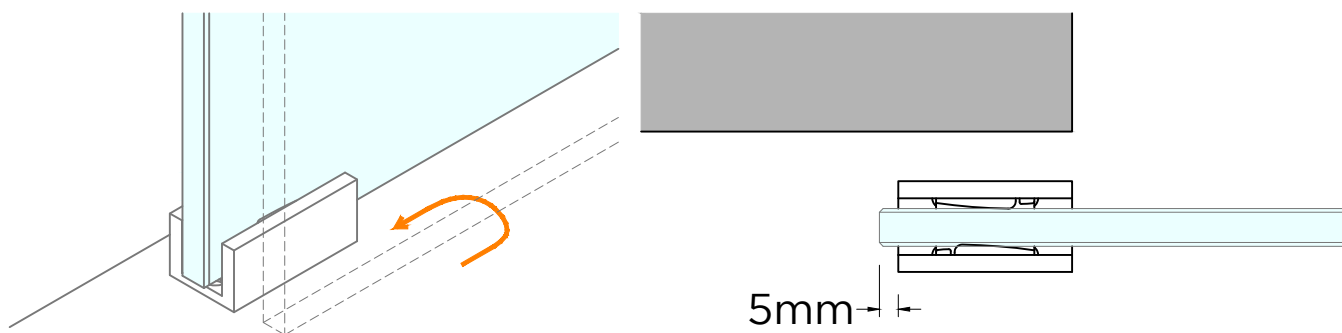
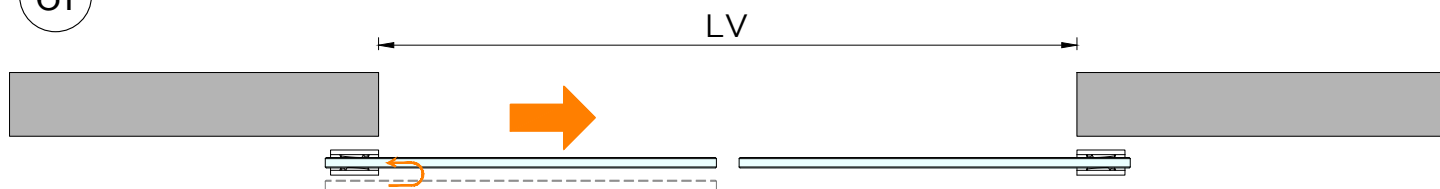



LMP6521C

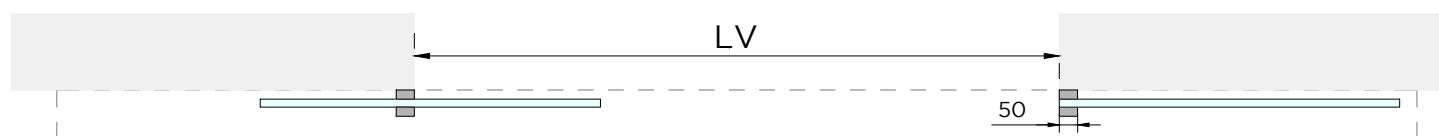
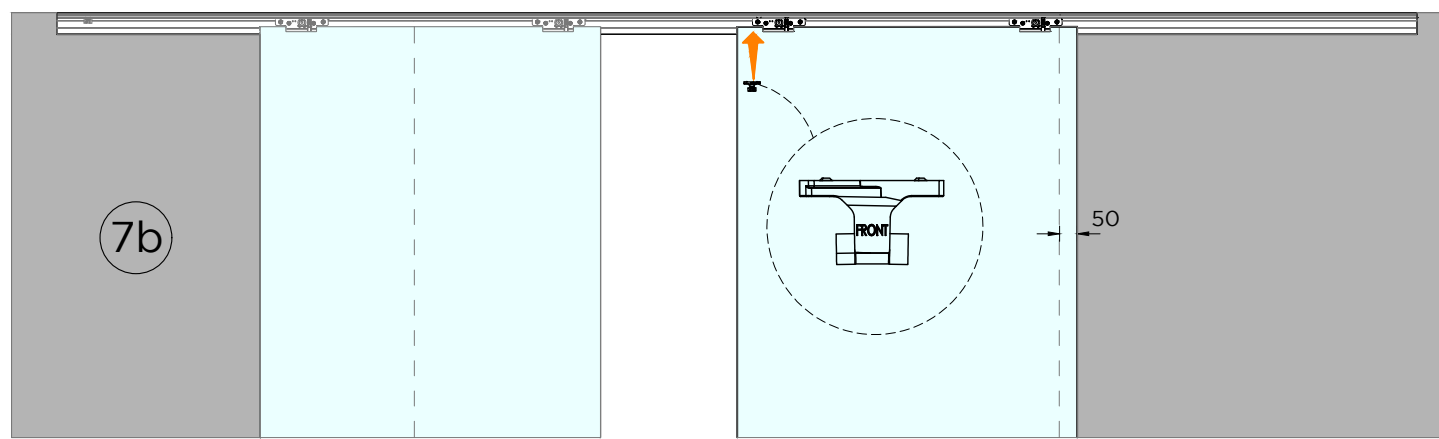
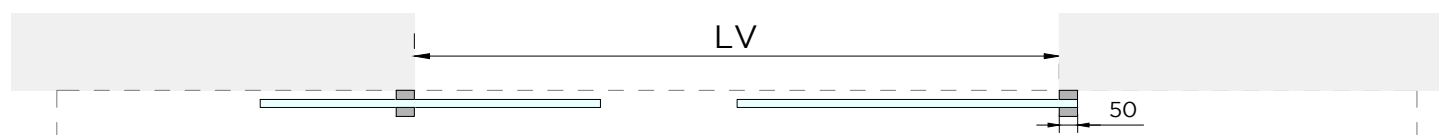
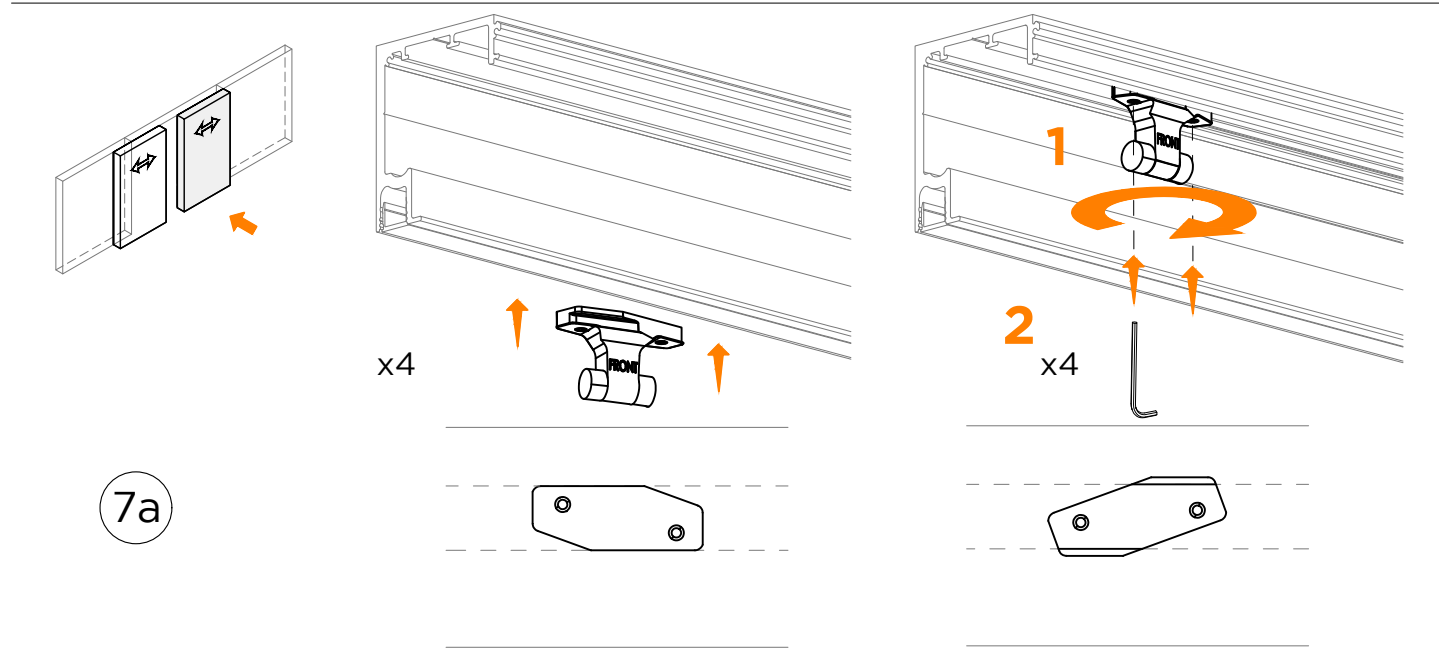

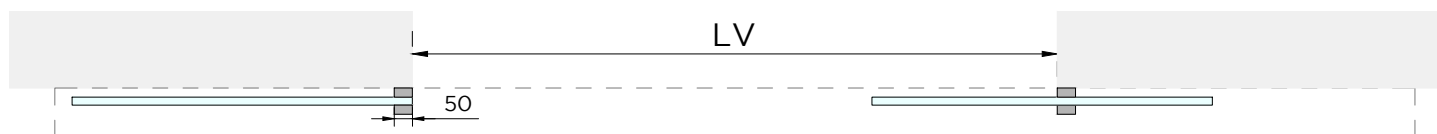
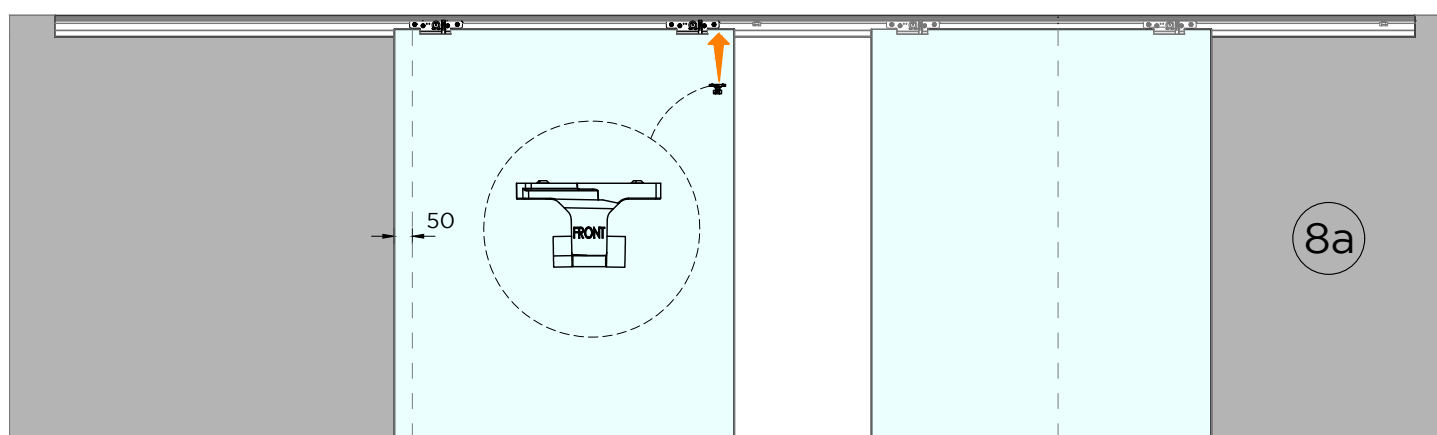
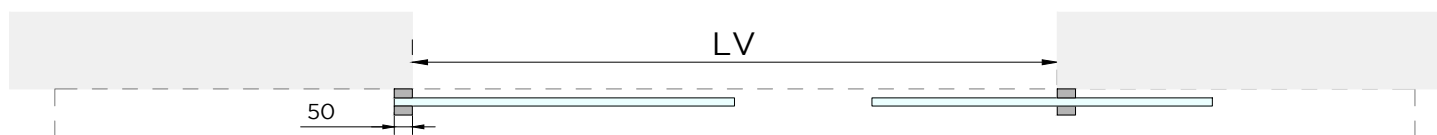
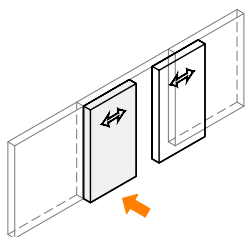

LMP6521C

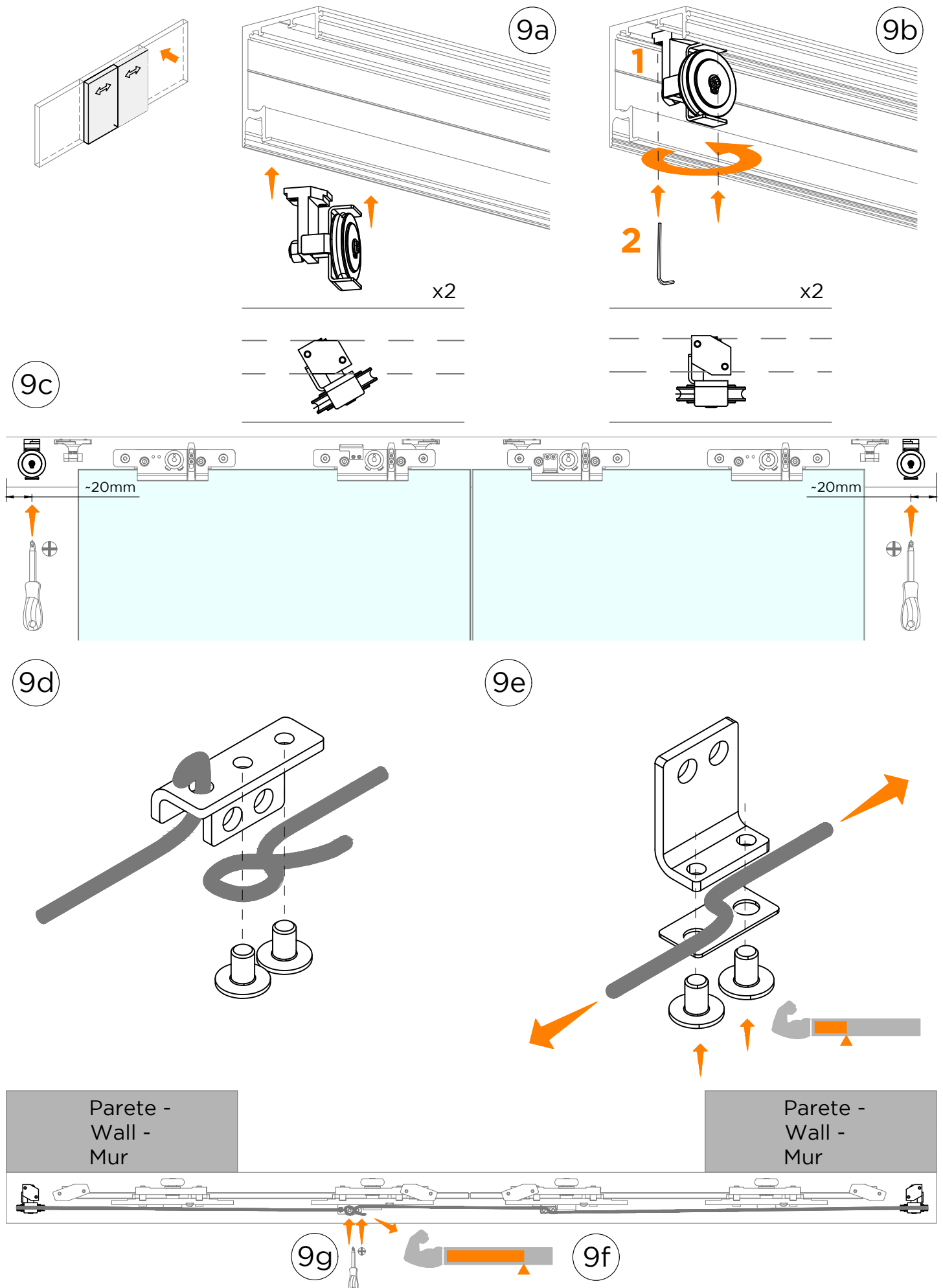

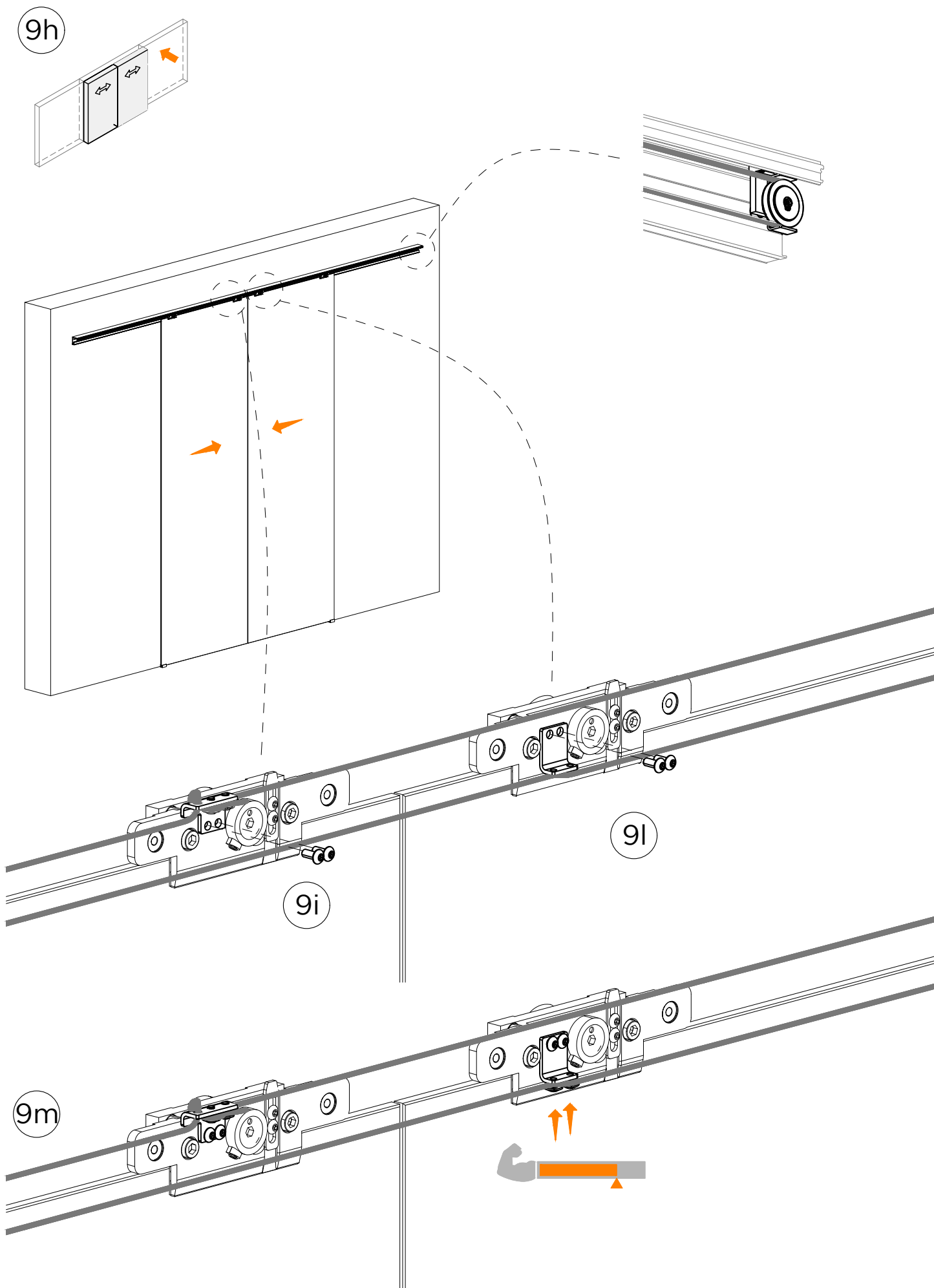

Optional

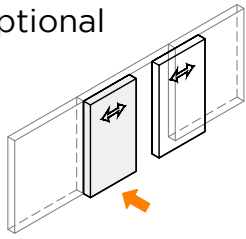

10a

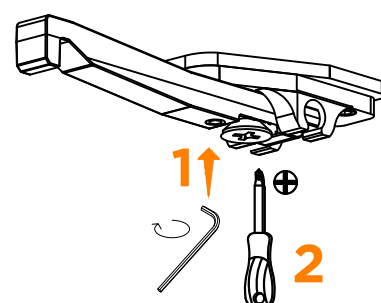
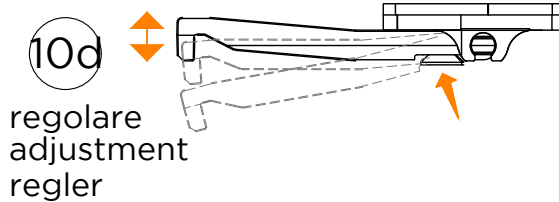
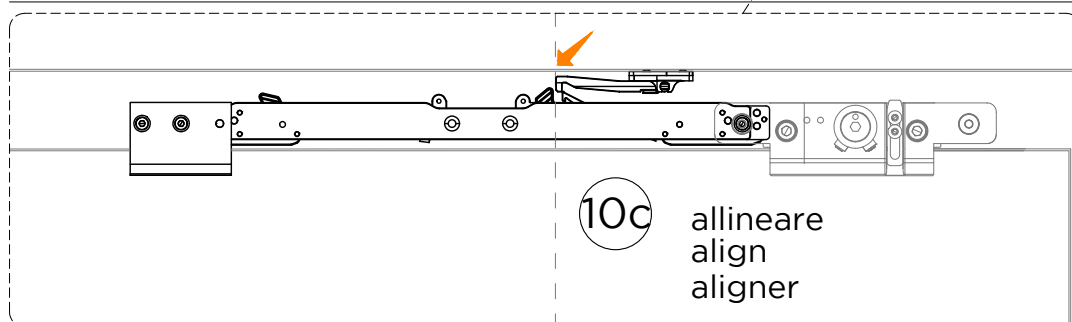
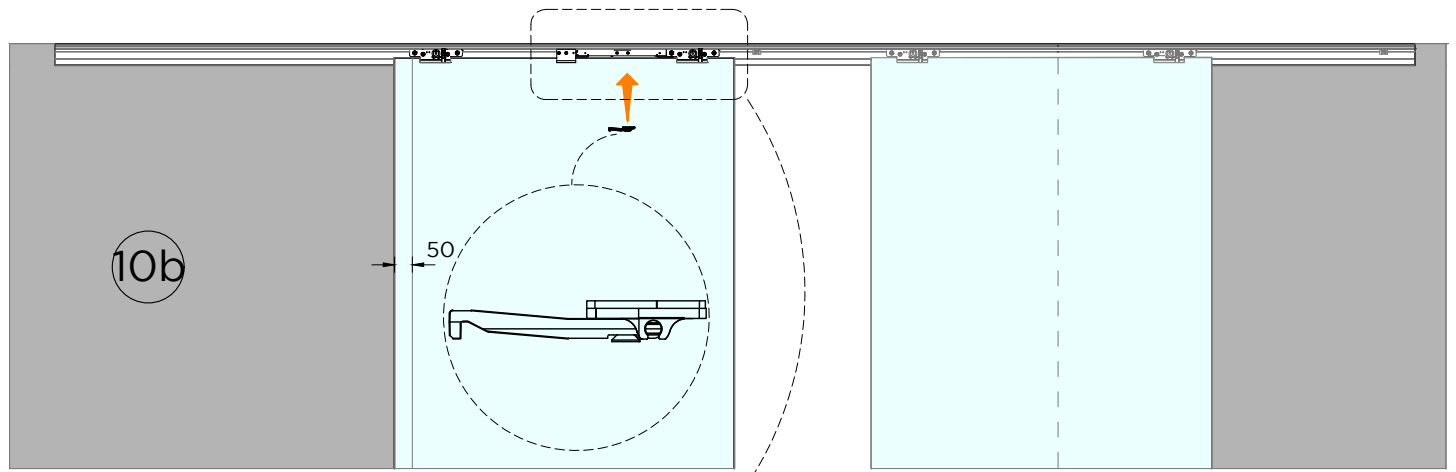
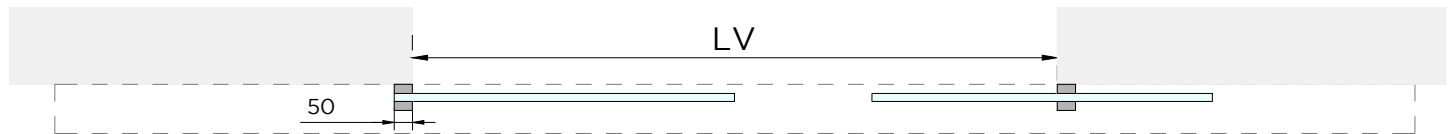
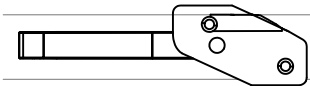
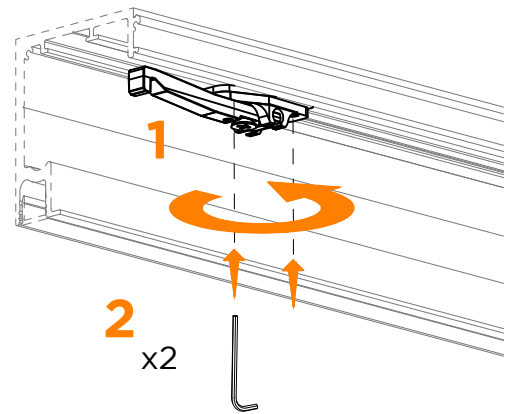
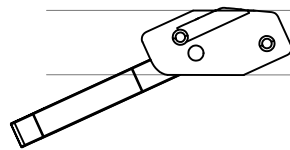
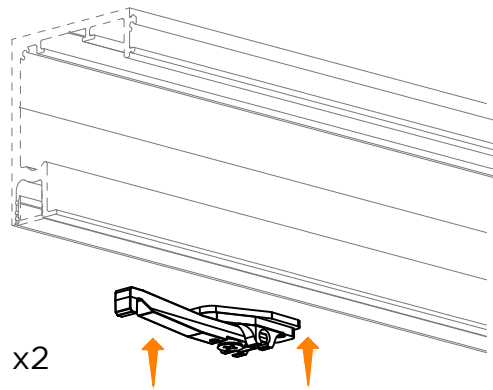

10e

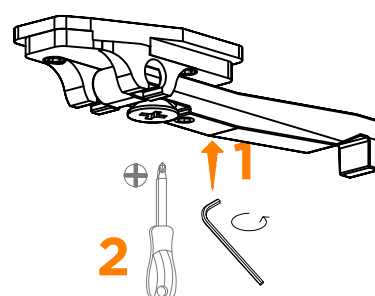
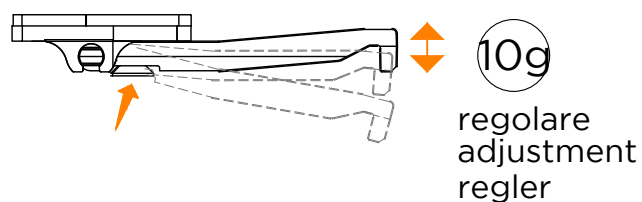
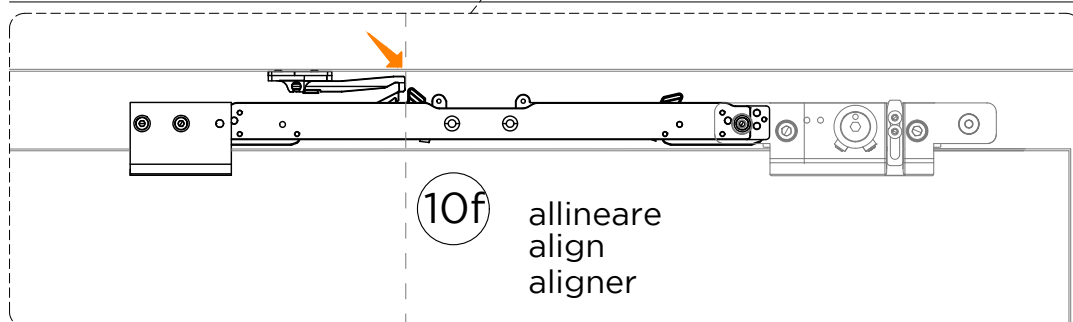
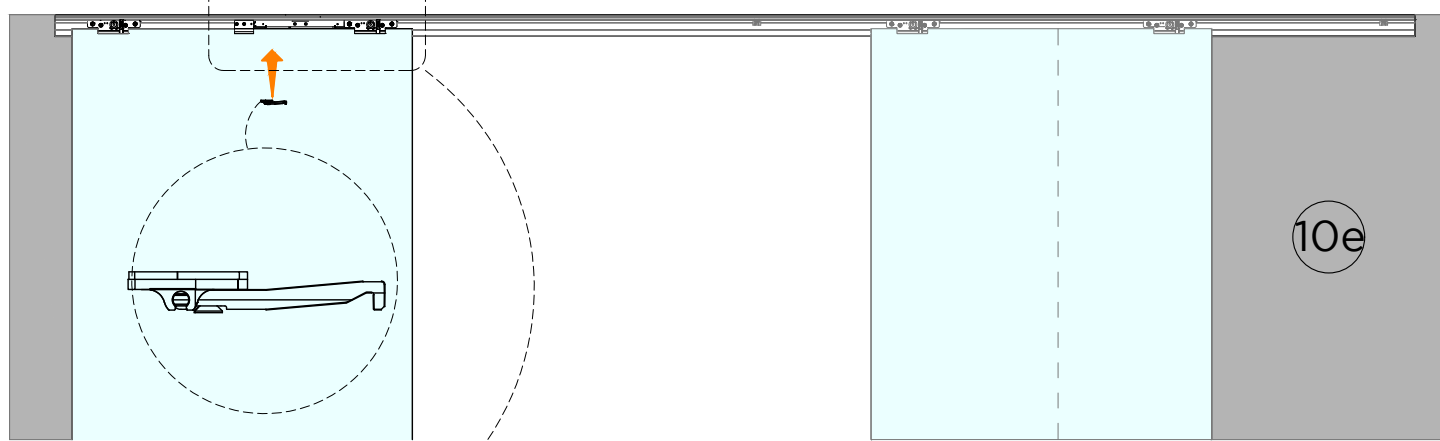
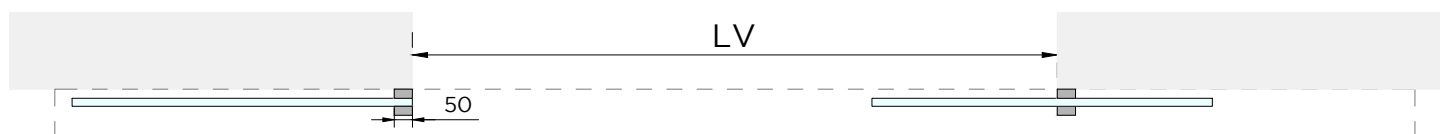
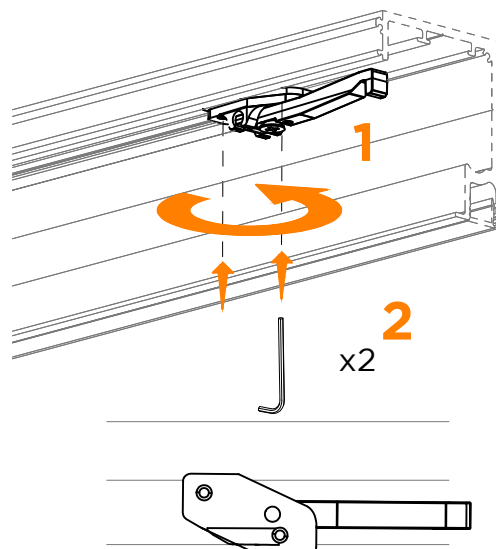
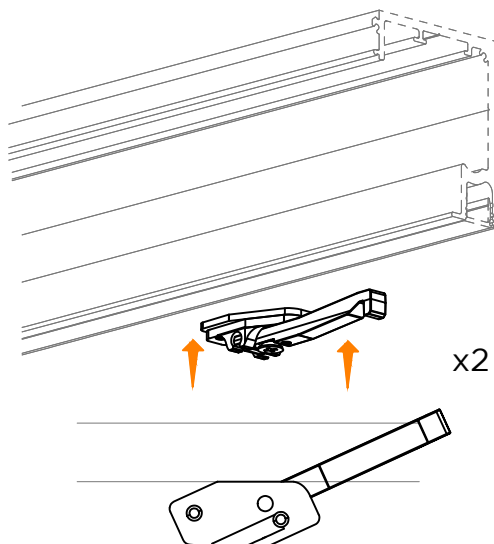
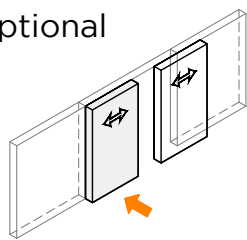

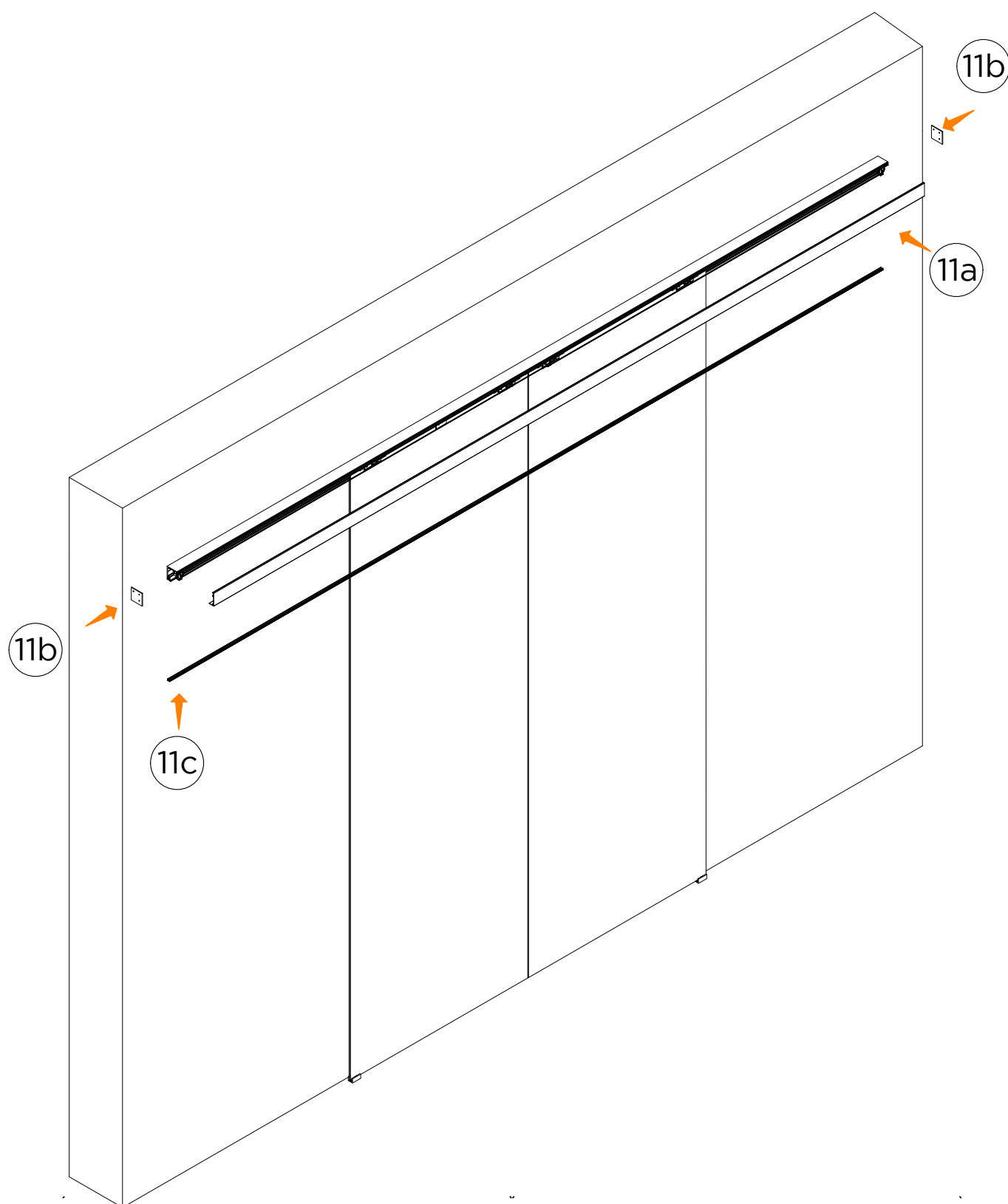

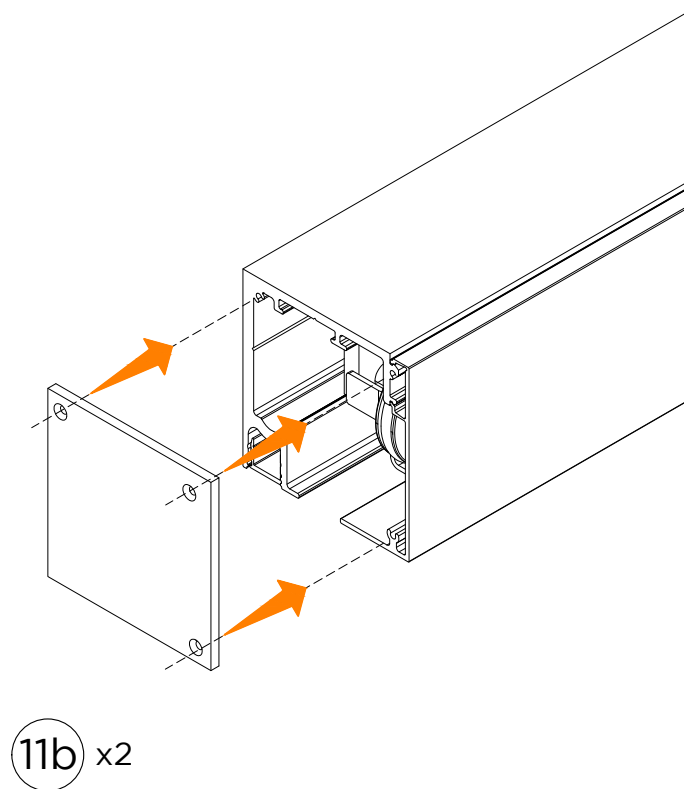
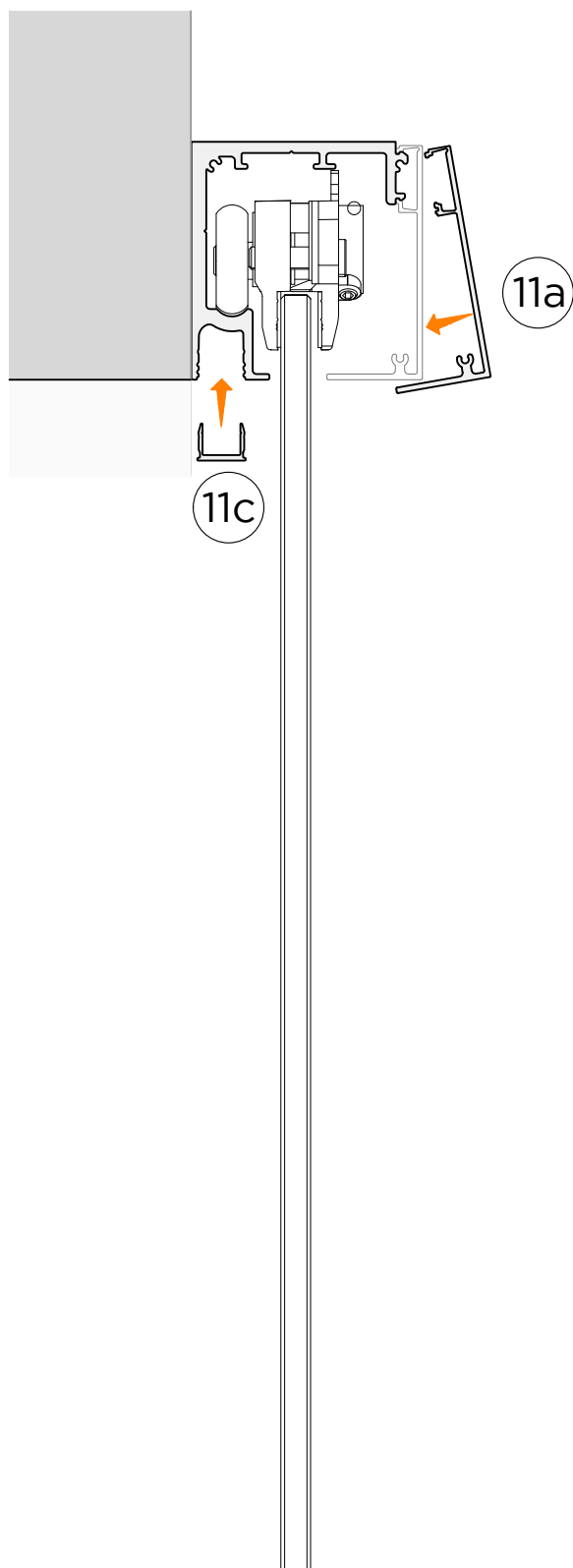



OPTIONAL AGGIUNTIVI  
ADDITIONAL OPTIONALS  
OPTIONS SUPPLÉMENTAIRES

A

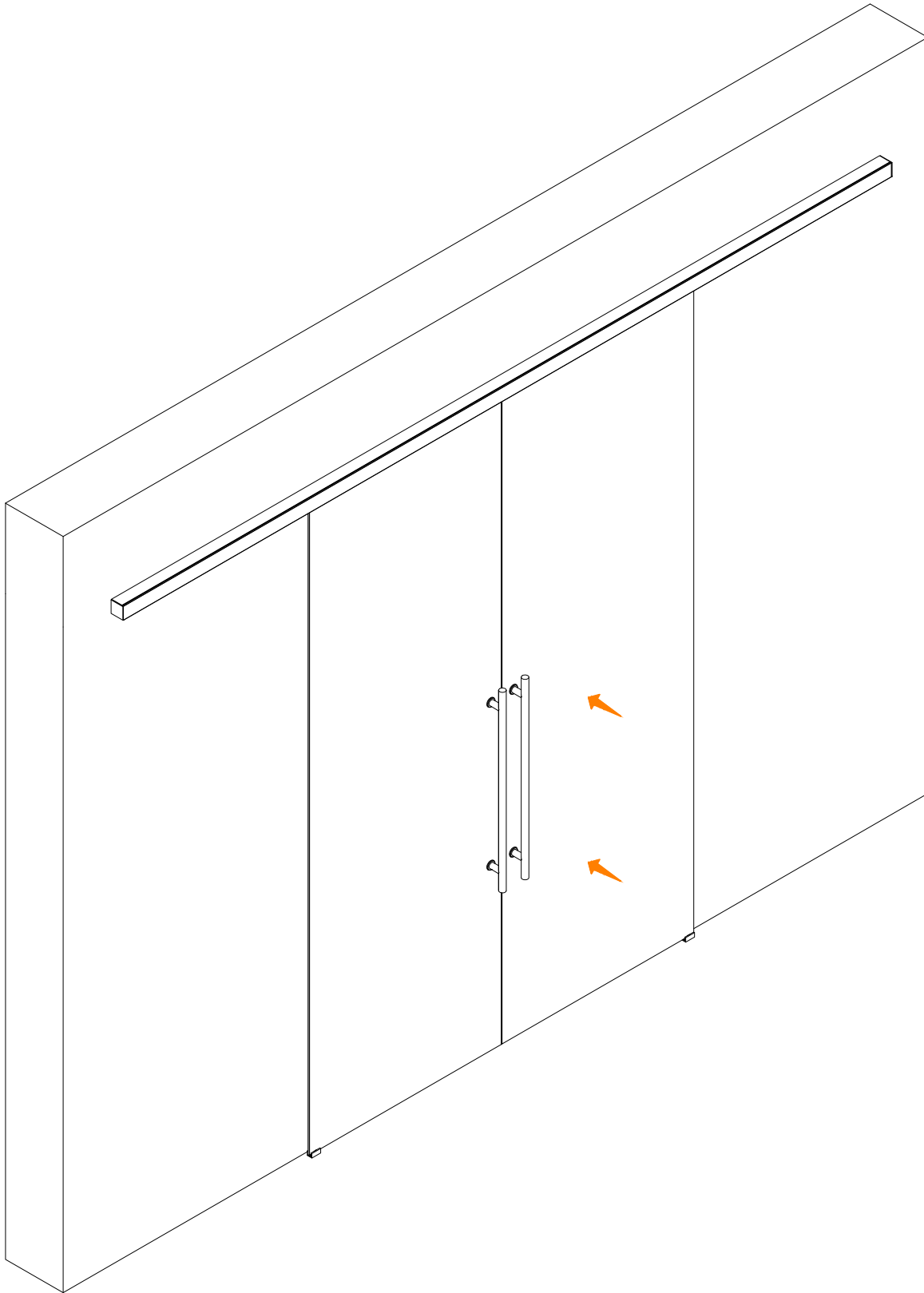

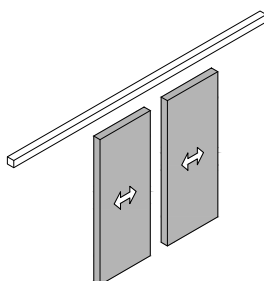

Tagli anta scorrevole -  
Sliding door cuts -  
Coupes de portes coulissantes

$(LV+100)/2$

$HV+13$

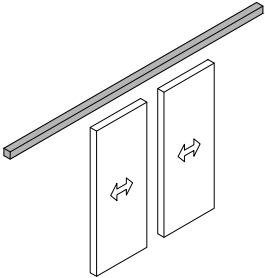

LM5864P

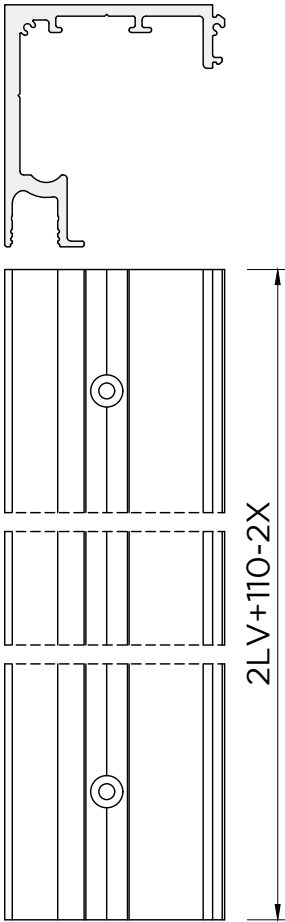

LM0064C

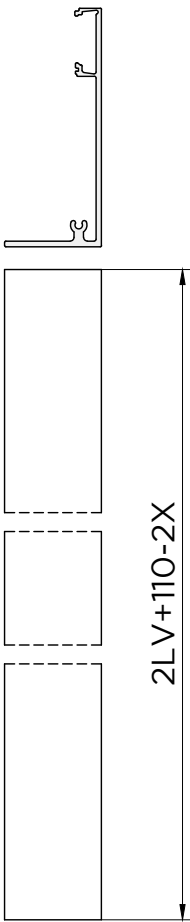

LMC13

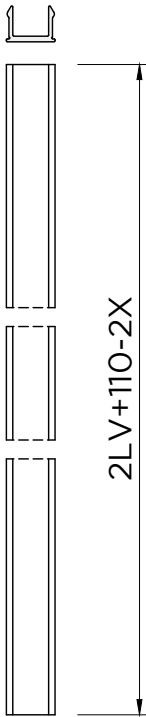



# LMP6521C

Le informazioni riportate hanno carattere esplicativo. Logli Massimo S.p.A. si riserva il diritto di apportare in ogni momento e senza preavviso modifiche di qualsivoglia natura a uno o più prodotti.

The information reported is explanatory in nature. Logli Massimo S.p.A. reserves the right to make changes at any time and without notice changes of any nature to one or more products.

Les informations rapportées sont de nature explicative. Logli Massimo S.p.A. se réserve le droit d'apporter des modifications à tout moment et sans préavis, des modifications de quelque nature que ce soit à un ou plusieurs produits.

---