

IMB2544

1

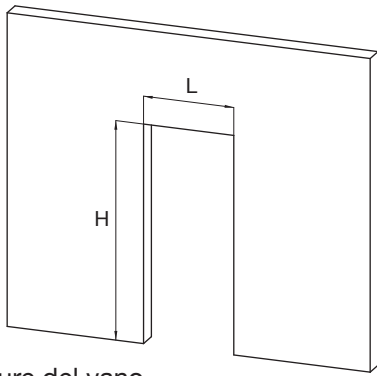

Ricavare le misure del vano

2

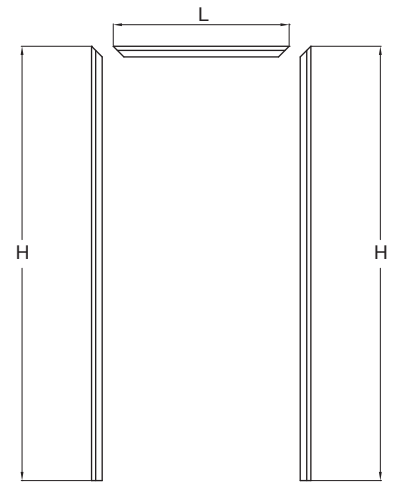

Tagliare a misura dei profili

3

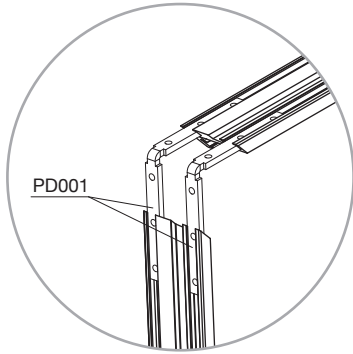

Inserire le squadrette di collegamento PD001 nelle apposite sedi

4

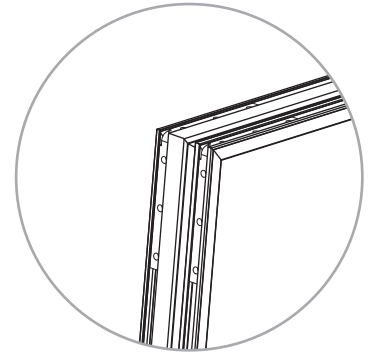

Accoppiare i profili chiudendo l'angolo e serrare i grani

5

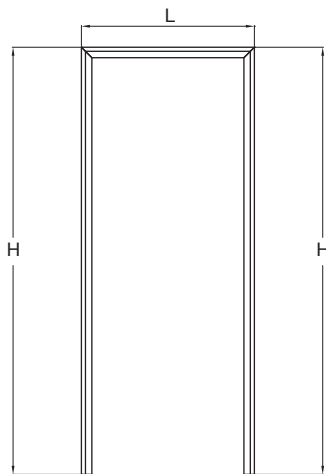

Comporre il telaio unendo i tre profili

6

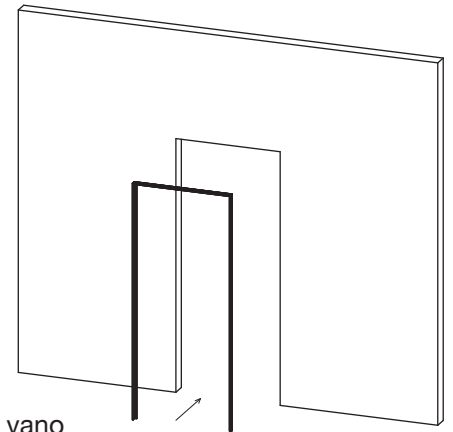

Inserire il telaio nel vano

7

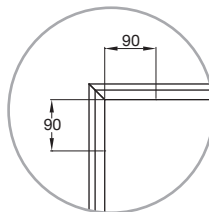
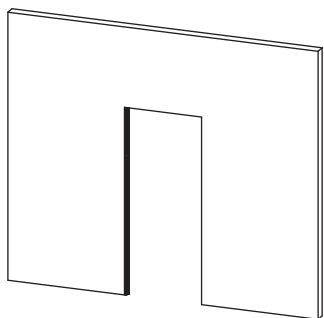

Attenzione:
non forare ad una quota inferiore a 90mm dall'angolo interno

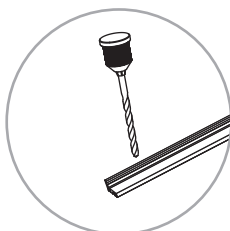

Linea guida di foratura

Mettere in bolla il telaio all'interno del vano e forare i profili per fissarli al muro seguendo la linea guida

8

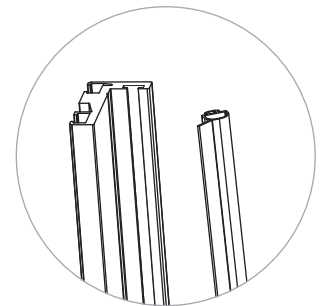

Inserire la guarnizione a pressione nella sede